

FCT TRUNNION MOUNTED SPLIT BODY BALL VALVES

MODELS HPA, HRA, DB

Higher Maximum Set Pressure, Lower Height Profile and Weight Savings

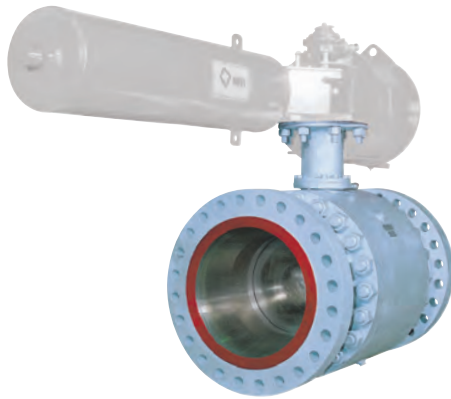

Pentair's FCT brand is a world leader in the design and manufacture of trunnion mounted ball valves for the oil and gas industry. For more than 50 years the FCT brand has been delivering high quality, innovative and competitive valve systems to the industry. FCT has continuously invested in new products and technology development and has actively worked with end-users to develop custom valves designed in accordance to customer specific requirements. Working with some of the largest energy companies, FCT has earned an excellent reputation as an international supplier of highly engineered trunnion mounted ball valves.

General application

The FCT split body trunnion mounted ball valves are widely used for upstream HIPPS, subsea, high pressure, high temperature, and cryogenic applications.

Technical data

| | |
|------------------|--|
| Models: | HPA (pin trunnion) HRA (plate trunnion) DB (pin trunnion) |
| Sizes: | 2" to 60", FB and RB |
| Pressure rating: | ANSI Class 150 to 2500, API 6A up to 10000 psi |
| Body materials: | Carbon steel, stainless steel, duplex and super duplex, special alloys Carbon steel with stainless steel or Inconel® overlay |
| Temp. range: | -321°F to +752°F [-196°C to +400°C] |
| Connections: | End to end dimensions per API 6D, ASME B16.10, API 6A Flanged RF and RTJ to ASME B16.5 [2" to 24", except 22"], MSS SP44 on 22" and ASME B16.47 [26" and above] Butt weld ends per ASME B16.25 Mechanical joint, hub on request |

Features and benefits

- Guided stem design minimizes operating torques which may result in lower actuation costs and longer service life benefits.
- Additional level of safety and reliability is provided by the double piston effect. In the event a seat is damaged, sealing is assured irrespective of the flow through the valve.
- Further safety assurance is delivered by a blow-out proof stem design which is shouldered and retained within the valve body.
- Operational benefits of checking seat integrity without disturbing the status of the pipeline are possible due to the double block and bleed feature, which allows venting and draining of the body cavity in both open and closed positions.
- Seat materials:

Soft seat material options (PFA, PEEK, PCTFE and Devlon®)

Metal seats (TCC)

- Seat designs:
 - Single piston effect (standard) provides self-relieving feature of body cavity over pressurization
 - Double piston effect provides an additional level of sealing capability and reliability
- Design, manufacturing and materials comply with the Essential Safety Requirements of the 97/23/EC Directive (PED).
- All valves designed to API 6D (ISO 14313) or API 6A (ISO 10423).
- Body wall thickness complies with ASME B16.34 (forged and/or cast).
- Full and reduced bore valves available.
- Antistatic device to BS 5351 (10 Ω under 12 Volt).
- Emergency sealant injection provision (seats and stem).
- Fire-tested to API 6FA and BS 6755 Part II.
- Testing to API 6D, API 6A, API 598, ISO 5208, BS 6755 Pt.1, API 17D.
- Marking to API 6D, API 6A, MSS-SP-25, PED.
- Available with manual operation, electric, pneumatic or hydraulic actuation.

FCT TRUNNION MOUNTED SPLIT BODY BALL VALVES

MODELS HPA, HRA, DB

FCT designs are available in a wide range of materials including various grades of carbon steel, stainless steel and specialty alloys. The wide selection of materials make FCT designs the valve of choice from standard to the most corrosive and severe applications. In addition to the materials listed in the table below FCT has manufacturing experience with many different grades and special alloys, ranging from, titanium alloys, nickel copper alloys, 6Mo stainless steels as well as additional alloys.

Please contact your sales representative for additional details.

| | |
|---|---|
| Carbon Steel | ASTM A105 |
| Low temperature Carbon Steel | ASTM A350 Gr. LF2/LF3 ASTM A694 Gr. F42 to F70 |
| Martensitic Stainless Steel | ASTM A182 Gr. F6A/F6NM |
| Martensitic precipitation-hardening Stainless Steel | ASTM A564 Gr. 630 (17-4 PH) |
| Austenitic Stainless Steel | ASTM A182 Gr. F316/F316L/F321 |
| Duplex and Super Duplex Stainless Steel | ASTM A182 Gr. F51/F53/F55 |
| Precipitation hardening iron base Superalloy | ASTM A638 Gr. 660 |
| Nickel Chromium Alloy Incoloy® Alloy 825 | Inconel® Alloy 625/718 |

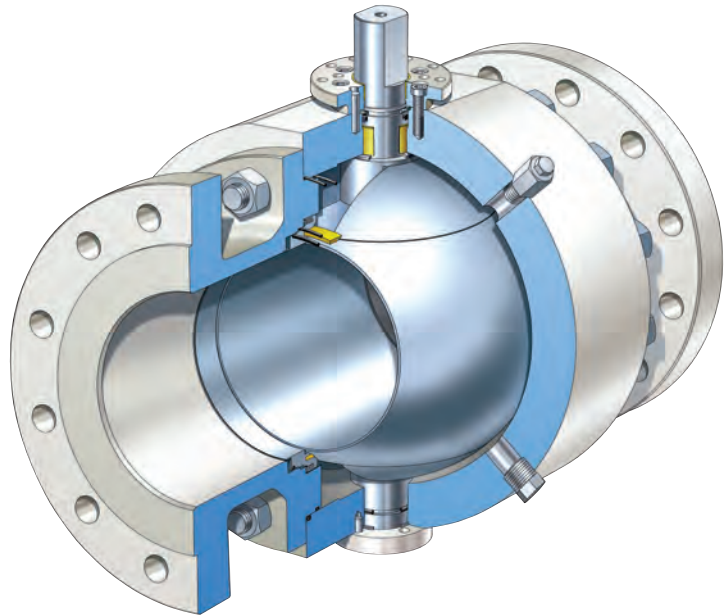

Standards

Valve design:

- API 6D/6A
- ASME B16.34
- ASME VIII
- ASME B31.3

Pressure/Temperature rating:

ASME B16.34

Face-to-face dimensions:

Flanged: API 6D, ASME B16.10, API 6A
Butt weld: Manufacturer's standard

Flanged ends:

- ASME B16.5 [2" to 24", except 22"], MSS SP44 on 22" and ASME B16.47 [26" and above]
- API 605, API 6A

Butt weld ends:

ASME B16.25

Bleed connection sizes:

API 6D/6A, MSS SP-45

Stem and ball design:

(incl. anti-static) BS 5351

Materials:

- ASTM
- AISI
- UNS
- NACE MR 01 03

Fire testing:

- API 6FA
- API 607
- BS 6755 Part II

Testing:

- API 6D - ISO 5208
- API 6A - BS 6755 Pt.1
- API 598 - API 17D

Marking:

- MSS SP-25
- API 6D/6A

Styles

Model HPA

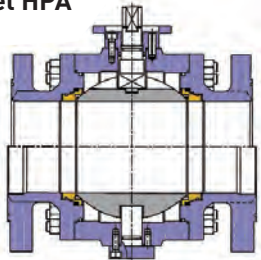

Three piece forged body design providing maximum material integrity integrating a "pin" trunnion.

Model HRA

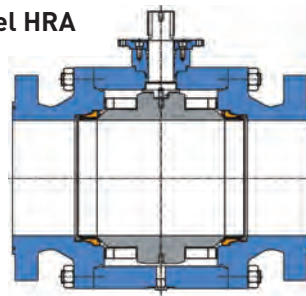

Three piece forged body design providing maximum material integrity integrating a "plate" trunnion suitable for larger valve sizes.

Model DB

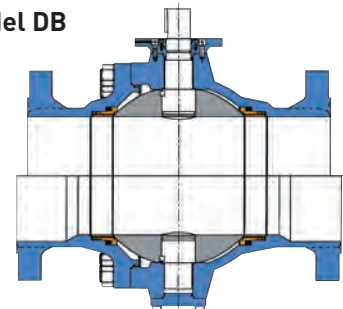

Two piece body design, providing weight optimization and fewer number of joints integrating a "pin" trunnion design. The DB body design offers the flexibility of utilizing castings or forgings, which is advantageous for the production of valves in special materials.

Principal range (full bore)

| Model | Size, in [DN] | Rating |
|-------|--------------------------|------------------|
| HPA | 2" to 8" [50 to 200] | ANSI 150 to 2500 |
| HRA | 10" to 16" [250 to 400] | ANSI 150 to 900 |
| | 18" to 24" [450 to 600] | ANSI 150 to 900 |
| DB | 2" to 24" [50 to 600] | API 10,000 |
| | 10" to 30" [250 to 750] | ANSI 2500 |
| | 18" to 42" [450 to 1050] | ANSI 1500 |
| | 26" to 60" [650 to 1500] | ANSI 150 to 900 |

Notes:

Illustrations represent Full bore design (top half)
Reduced bore design (bottom half)

Model DB is also used in the range 2" to 24" [50 to 600], for special material constructions, such as Duplex, Super Duplex, 6Mo, Titanium, Bronze etc.

Model DB may also be constructed in a 3-piece, forged design, where this is appropriate to achieve the desired material and delivery requirements.

FCT TRUNNION MOUNTED SPLIT BODY BALL VALVES

MODELS HPA, HRA, DB

Standard Design Principles

Seat Ring Design

The standard seat ring of FCT trunnion mounted ball valves is designed to give the "Single Piston Effect". With upstream line pressure forcing the seat ring onto the ball, from either flow direction, a positive seal is obtained. At low upstream pressures (below 150 psi) and at the downstream seat, the seating force is provided by the seat springs.

Coil springs are utilized in all models.

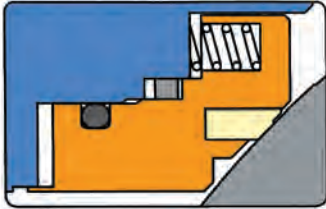

Cavity Overpressure Relief

Should the pressure between the seats increase and become greater than the line pressure, or spring force, the seats are able to relieve the pressure excess to the downstream line by forcing the seat ring away from the ball. This cavity relieving mechanism automatically ensures that the valve body cannot be subject to dangerous internal overpressure.

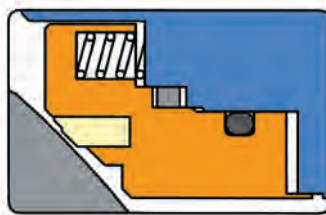

Fire Safety

All FCT ball valves are covered by fire test certification in accordance with API 6FA, BS6755 Pt II and API 607.

The design incorporates back-up graphite seals (behind O-rings or Lip-seals) and secondary metal to metal seating contact at the ball face.



Double Block and Bleed

Relieving the pressure between the seats, via the vent plug, will cause both seat rings to be loaded onto the ball, effecting a seal both upstream and downstream. This will occur with the valve in either the open or closed position. With the cavity pressure relieved, it will be possible to check that both seats are holding tight. Seat integrity can be checked without disturbing the pipeline status.

Drain and Vent Facilities

The standard design incorporates plugged drain ports and vent relief plugs.

Stem Arrangement

The stem and bonnet arrangement provide the anti-blowout and anti-static features required by the design specifications.

In all models the anti-blowout feature is achieved by shouldering the stem against the body.

Stem Sealing

The triple stage stem sealing is comprised of a primary, self-pressurizing lip seal "1", with secondary O-ring "2", backed by a graphite seal "3" for fire security.

The HPA model, when lever operated, also incorporates a scraper ring, outside the stem bearing, to prevent ingress of solid materials into the stem seal mechanism.

Bearings

The differential load produced by line pressure acting on the ball, is carried by the stem and trunnion bearings "4". These self-lubricating,

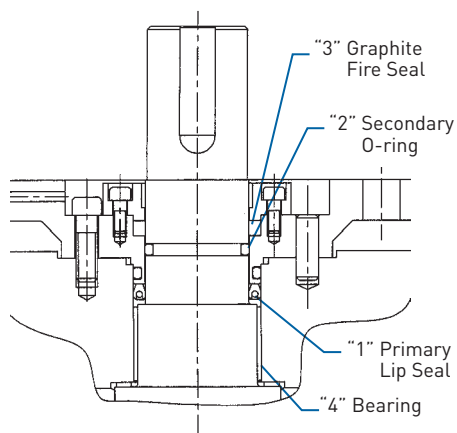

PTFE impregnated bearings maintain low operating torque and maximize service life.

Emergency Shut Down Valves (ESDV)

Valves which are specified as ESD valves, are equipped with actuators which ensure their positive and rapid operation in an emergency.

In the case of such critical equipment, full details of the application conditions should be provided at the enquiry stage.

FCT valves are available with SIL approval to IEC 61508 Standard, for ESD service.

HIPS/HIPPS

FCT has developed procedures conforming to the High Integrity Protection System (HIPS) and the High Integrity Pressure Protection System (HIPPS), to provide the highest level of safety

risk analysis for gas process and pipeline installations. FCT trunnion mounted ball valves have been assessed according to IEC 61508 and found to comply with SIL3 in the case of a single valve configuration and SIL4 where two valves are used in series.

Special Coatings

The wear resistance and corrosion resistance of seat and ball materials may be enhanced by the use of weld overlays, electroless nickel plating (ENP), tungsten carbide coating or other surface preparations, on seat ring, stem, ball and body sealing areas.

Sour Service

Valves are available, conforming to the recommendations of the NACE specification MR 01-75/ISO 15156, for use on applications where the presence of wet H₂S generates a risk of stress corrosion cracking.

HIC and SCC corrosion test certificates can be provided on request.

Explosive Decompression

Wherever valves are used in high pressure gas applications, there is the possibility of gas being absorbed into the molecular structure of elastomeric O-rings. These O-ring materials may be subject to explosive decompression.

To eliminate this possibility, special AED O-rings or lip seals, suitable for such service conditions, are available.

Transition and Pup Pieces

Valves with butt weld ends may be fitted with pup pieces in order to eliminate the risk of seat damage by heat transfer during welding and post weld heat treatment.

Similarly, transition pups may be supplied to facilitate on-site welding of valves to pipework of different materials.

Valve Accessories

Other accessories available include:

- Locking devices
- Lifting lugs
- Support feet
- Chain wheel operation

Actuation Packages

FCT has extensive experience in delivering total control packages, including the fitting and testing of all types of actuation and a complete range of control accessories.

Fully functional test facilities enable FCT to

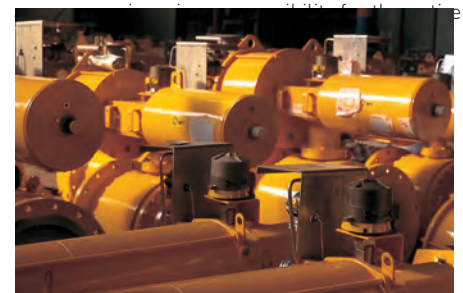

FCT TRUNNION MOUNTED SPLIT BODY BALL VALVES

MODELS HPA, HRA, DB

Special Applications and Options

Emergency Sealant Injection

Provision is made for the injection of supplementary sealing material for emergency repair purposes, on all valves of 16" [DN 400] and above.

This facility is available, on request, on valve sizes below 14" [DN 350].

Sealant injection facilities are fitted at both seat areas and the stem seal area on sizes 6" [DN 150] and above. On sizes 2" to 4" [DN 50 to 100] sealant injection is into the body cavity.

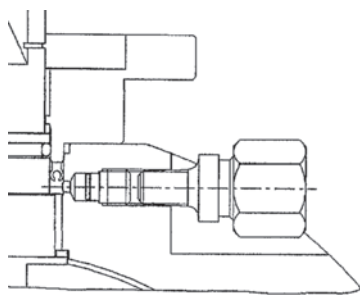
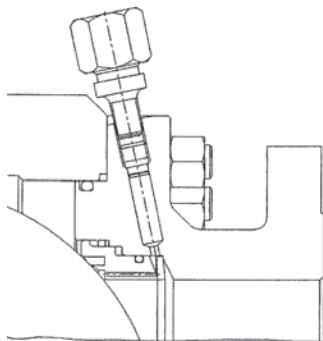

Double Piston Effect

The seat ring design may be modified to provide a Double Piston Effect (DPE). This feature adds an additional level of safety and reliability to the sealing capability of the valve, by providing a positive downstream seal in the event of an upstream failure. DPE feature allows the seat surfaces to be loaded onto the ball surface no matter which seat is subject to pressure, even if the pressure is between the seats. DPE feature eliminates the self-relieving function; therefore, it is essential to incorporate a safety relief mechanism, to prevent dangerous over-pressurization of the valve body in liquid application.

When using Double Piston Effect seats, the integrity of both seats may be confirmed by pressurizing the valve cavity (without pressurizing the whole line).

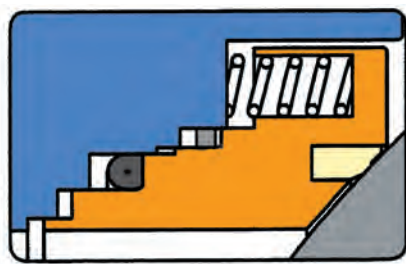

Upstream Seat

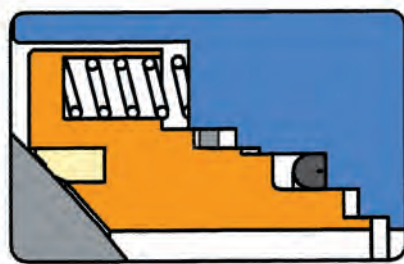

Downstream Seat

Extreme Services

For applications beyond the capabilities of soft seated valves, such as abrasive or elevated temperature service, metal seated designs are available for all sizes and pressure classes.

Metal/Soft

Wherever the durability of metal seating is required, but the service temperature does not preclude the use of thermoplastic seating, FCT valves may be provided with a metal/soft seat combination. The elastomeric seal provides a gas tight shut-off in normal conditions, with the back up of metal seating.

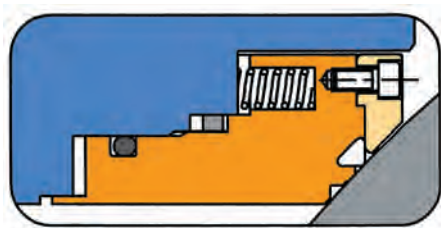

Metal/Metal

For applications where elastomeric seats would be inappropriate, such as very high pressure, temperatures above 392°F [200°C], or where solid particles are present, valves are provided with metal/metal seating, incorporating tungsten carbide coating.

For high temperature service the valves will be fitted with extension bonnets, to attain acceptable ambient temperature and ensure the safety of the operator.

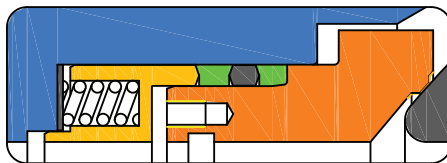

High Temperature Service

For services at temperatures above 392°F [200°C], models are available with the following features:

- Extended bonnet
- Graphite seals
- Tungsten carbide seat facing (150µ)
- Metallic bearings
- Dynamic, live loaded, gland bolting

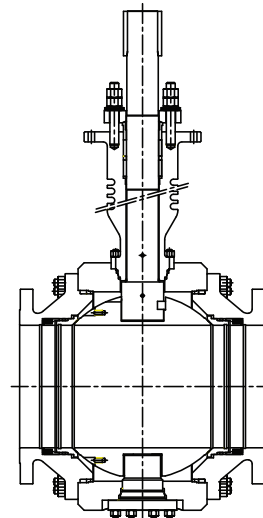

Cryogenic Temperature Service

For services at temperatures down to -321°F [-196°C], models are available with the following features:

- Extended bonnet
- Graphite seals
- PCTFE seat insert
- Dynamic, live loaded, gland bolting

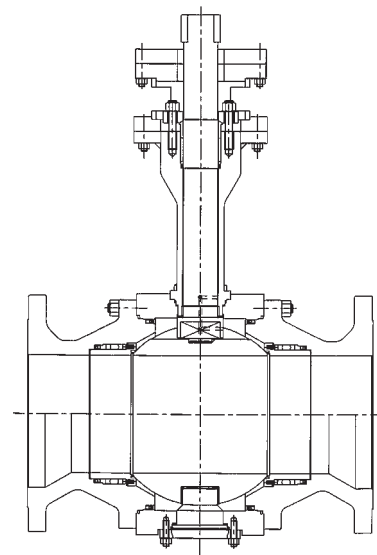

FCT TRUNNION MOUNTED SPLIT BODY BALL VALVES

MODELS HPA, HRA, DB

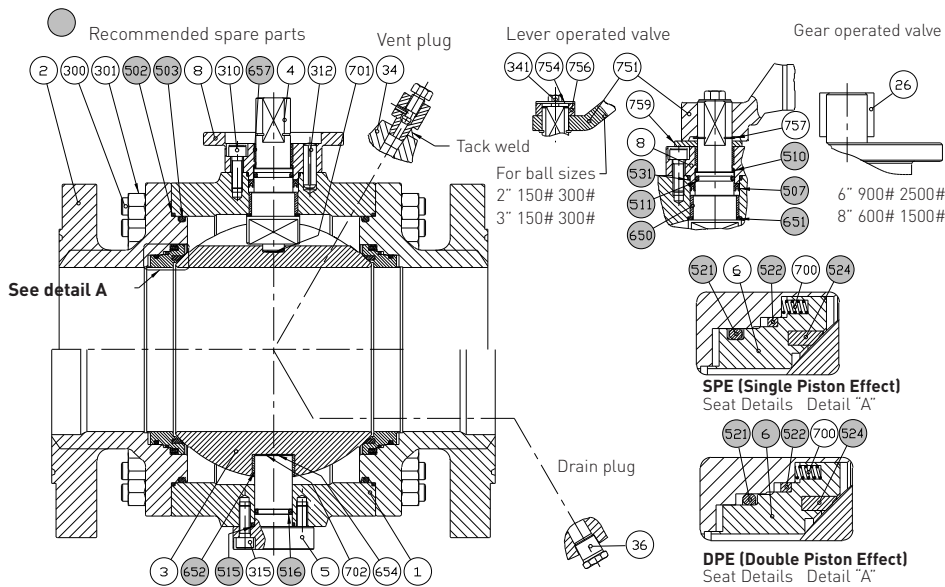

Valve size range:
2" to 8" FB
3" to 10" RB

Pressure Rating:
ANSI 150 to ANSI 2500

Note:

Ball and seat materials change according to the pressure rating

Valve part list with BOM – HPA model, soft seated, Class 150 to 600

| Item | Qty | Designation | Carbon Steel | Carbon Steel Body | Stainless Steel Standard Material | Notes |
|------|-----|--------------------|------------------------------------|-----------------------------|-----------------------------------|-------|
| | | | Standard Material | with Stainless Steel trim | see note [2] | |
| 1 | 1 | Body | ASTM A 350 Gr. LF2 | ASTM A 350 Gr. LF2 | ASTM A 182 Gr. F316 | |
| 2 | 2 | Body flange | ASTM A 350 Gr. LF2 | ASTM A 350 Gr. LF2 | ASTM A 182 Gr. F316 | |
| 3 | 1 | Ball | A 350 Gr. LF2 +75µm ENP / AISI 410 | ASTM A 182 Gr. F316 | ASTM A 182 Gr. F316 | |
| 4 | 1 | Stem | A 276 Gr. UNS S41000 (AISI 410) | A 564 Gr. 630 (UNS S17400) | A 564 Gr. 630 (UNS S17400) | |
| 5 | 1 | Trunnion | A 276 Gr. UNS S41000 (AISI 410) | A 564 Gr. 630 (UNS S17400) | A 564 Gr. 630 (UNS S17400) | |
| 6 | 2 | Seat ring | A 276 Gr. UNS S41000 (AISI 410) | ASTM A 182 Gr. F316 | ASTM A 182 Gr. F316 | |
| 8 | 1 | Adaptor flange | ASTM A 350 Gr. LF2 | ASTM A 350 Gr. LF2 | ASTM A 182 Gr. F316 | |
| 26 | [*] | Shaft key | AISI 1048 | AISI 1048 | AISI 1048 | |
| 34 | 1 | Vent plug | ASTM A 350 Gr. LF2 | ASTM A 350 Gr. LF2 | ASTM A 182 Gr. F316 | |
| 36 | 1 | Drain plug | ASTM A 350 Gr. LF2 | ASTM A 350 Gr. LF2 | ASTM A 182 Gr. F316 | |
| 300 | [*] | Stud bolt | ASTM A 320 Gr. L7M | ASTM A 320 Gr. L7M | ASTM A 320 Gr. B8M Class 2 | |
| 301 | [*] | Nut | ASTM A 194 Gr. 7M | ASTM A 194 Gr. 7M | ASTM A 194 Gr. 7M | |
| 310 | [*] | Screw | ASTM A 320 Gr. L7M | ASTM A 320 Gr. L7M | ASTM A 320 Gr. B8M Class 2 | |
| 312 | 1 | Pin | AISI 1075 | AISI 1075 | ASTM A 182 Gr. F316 | |
| 315 | [*] | Screw | ASTM A 320 Gr. L7M | ASTM A 320 Gr. L7M | ASTM A 320 Gr. B8M Class 2 | |
| 341 | 1 | Screw | ASTM A 320 Gr. L7M | ASTM A 320 Gr. L7M | ASTM A 320 Gr. B8M Class 2 | [1] |
| 502 | 2 | Fire-safe gasket | Expanded Graphite | Expanded Graphite | Expanded Graphite | |
| 503 | 2 | O-ring seal | FKM | FKM | FKM | |
| 507 | 1 | Lip seal | PTFE + ELGILOY Spring | PTFE + ELGILOY Spring | PTFE + ELGILOY Spring | |
| 510 | 1 | Fire-safe gasket | Expanded Graphite | Expanded Graphite | Expanded Graphite | |
| 511 | 1 | O-ring seal | FKM | FKM | FKM | |
| 515 | 1 | Fire-safe gasket | Expanded Graphite | Expanded Graphite | Expanded Graphite | |
| 516 | 1 | O-ring seal | FKM | FKM | FKM | |
| 521 | 2 | O-ring seal | FKM | FKM | FKM | |
| 522 | 2 | Fire-safe gasket | Expanded Graphite | Expanded Graphite | Expanded Graphite | |
| 524 | 2 | Seat insert | PFA / PCTFE / Nylon | PFA / PCTFE / Nylon | PFA / PCTFE / Nylon | |
| 531 | 1 | Fire-safe gasket | Expanded Graphite | Expanded Graphite | Expanded Graphite | |
| 650 | 1 | Bearing | C. S + PTFE Lining | C. S + PTFE Lining | 316 SS + PTFE Lining | |
| 651 | 1 | Thrust washer | C. S + PTFE Lining | C. S + PTFE Lining | 316 SS + PTFE Lining | |
| 652 | 1 | Bearing | C. S + PTFE Lining | C. S + PTFE Lining | 316 SS + PTFE Lining | |
| 654 | 1 | Thrust washer | C. S + PTFE Lining | C. S + PTFE Lining | 316 SS + PTFE Lining | |
| 657 | 1 | Bearing | C. S + PTFE Lining | C. S + PTFE Lining | 316 SS + PTFE Lining | |
| 700 | [*] | Spring | ALLOY X 750 | ALLOY X 750 | ALLOY X 750 | |
| 701 | 1 | Anti-static spring | AISI 302 | AISI 302 | AISI 316 | |
| 702 | 1 | Anti-static spring | AISI 302 | AISI 302 | AISI 316 | |
| 751 | 1 | Lever | C. S. Zinc Plated / Painted | C. S. Zinc Plated / Painted | C. S. Zinc Plated / Painted | [1] |
| 754 | 1 | Washer | C. S. Zinc Plated | C. S. Zinc Plated | C. S. Zinc Plated | [1] |
| 756 | 1 | Spacer | C. S. Zinc Plated | C. S. Zinc Plated | Stainless Steel | [1] |
| 757 | 1 | Stopper spring | Low Alloy Steel | Low Alloy Steel | Stainless Steel | [1] |
| 759 | 1 | Stop plate | AISI 1038 Zinc Plated | AISI 1038 Zinc Plated | AISI 1038 Zinc Plated | [1] |

Notes:

- *) Quantity is according with valve size and pressure rating.
- 1) Only supplied on lever operated valves.
- 2) Applicable for valve sizes 2" to 4" only. For 6" and above valve sizes, see "DB" model.

FCT TRUNNION MOUNTED SPLIT BODY BALL VALVES

MODELS HPA, HRA, DB

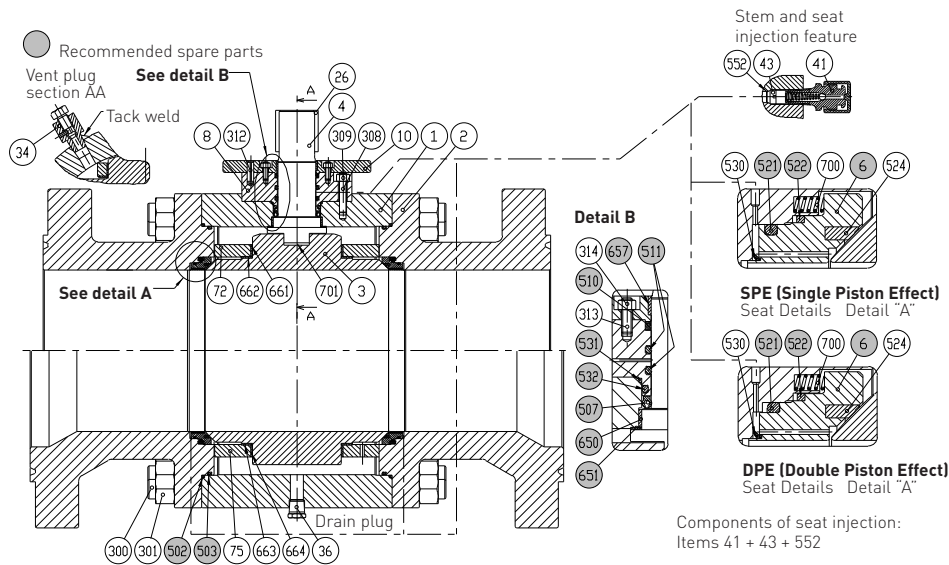

Valve size range:
10" to 24" FB
12" to 30" RB
Pressure Rating:
ANSI 150 to ANSI 600

Valve part list with BOM – HRA Model, soft seated

| Item | Qty | Designation | Carbon Steel | Carbon Steel Body |
|------|-----|---------------------------|------------------------------------|----------------------------|
| | | | Standard Material | with Stainless Steel trim |
| 1 | 1 | Body | ASTM A 350 Gr. LF2 | ASTM A 350 Gr. LF2 |
| 2 | 2 | Body flange | ASTM A 350 Gr. LF2 | ASTM A 350 Gr. LF2 |
| 3 | 1 | Ball | A 350 Gr. LF2 +75µm ENP / AISI 410 | ASTM A 182 Gr. F316 |
| 4 | 1 | Stem | AISI 4140 +75µm ENP / AISI 410 | A 564 Gr. 630 (UNS S17400) |
| 6 | 2 | Seat ring | A 350 Gr. LF2 +75µm ENP / AISI 410 | ASTM A 182 Gr. F316 |
| 8 | 1 | Adaptor flange | ASTM A 350 Gr. LF2 | ASTM A 350 Gr. LF2 |
| 10 | 1 | Upper cap | ASTM A 350 Gr. LF2 | ASTM A 350 Gr. LF2 |
| 26 | [*] | Shaft key | AISI 4140 | AISI 4140 |
| 34 | 1 | Vent plug | ASTM A 182 Gr. F316 | ASTM A 182 Gr. F316 |
| 36 | 1 | Drain plug | ASTM A 182 Gr. F316 | ASTM A 182 Gr. F316 |
| 41 | [*] | Injection fitting | ASTM A 182 Gr. F316 | ASTM A 182 Gr. F316 |
| 43 | [*] | Mini check | ASTM A 182 Gr. F316 | ASTM A 182 Gr. F316 |
| 72 | 1 | Upper ball trunnion plate | ASTM A 516 Gr. 60 | ASTM A 516 Gr. 60 |
| 75 | 1 | Lower ball trunnion plate | ASTM A 516 Gr. 60 | ASTM A 516 Gr. 60 |
| 300 | [*] | Stud bolt | ASTM A 320 Gr. L7M | ASTM A 320 Gr. L7M |
| 301 | [*] | Nut | ASTM A 194 Gr. 7M | ASTM A 194 Gr. 7M |
| 308 | [*] | Stud bolt | ASTM A 320 Gr. B8M | ASTM A 320 Gr. B8M |
| 309 | [*] | Nut | ASTM A 194 Gr. 8M | ASTM A 194 Gr. 8M |
| 312 | 2 | Pin | AISI 1075 | AISI 1075 |
| 313 | [*] | Stud bolt | ASTM A 320 Gr. B8M | ASTM A 320 Gr. B8M |
| 314 | [*] | Nut | ASTM A 194 Gr. 8M | ASTM A 194 Gr. 8M |
| 502 | 2 | Fire-safe gasket | Expanded Graphite | Expanded Graphite |
| 503 | 2 | O-ring seal | FKM | FKM |
| 507 | 1 | Lip seal | PTFE + ELGILOY Spring | PTFE + ELGILOY Spring |
| 510 | 1 | Fire-safe gasket | Expanded Graphite | Expanded Graphite |
| 511 | 2 | O-ring seal | FKM | FKM |
| 521 | 2 | O-ring seal | FKM | FKM |
| 522 | 2 | Fire-safe gasket | Expanded Graphite | Expanded Graphite |
| 524 | 2 | Seat insert | PFA / PCTFE / Nylon | PFA / PCTFE / Nylon |
| 530 | 2 | Garter ring | PTFE | PTFE |
| 531 | 1 | Fire-safe gasket | Expanded Graphite | Expanded Graphite |
| 532 | 1 | O-ring seal | FKM | FKM |
| 552 | [*] | Gasket | PTFE | PTFE |
| 650 | 1 | Bearing | C. S + PTFE Lining | C. S + PTFE Lining |
| 651 | 1 | Thrust washer | C. S + PTFE Lining | C. S + PTFE Lining |
| 657 | 1 | Bearing | C. S + PTFE Lining | C. S + PTFE Lining |
| 661 | 1 | Bearing | C. S + PTFE Lining | C. S + PTFE Lining |
| 662 | 1 | Bearing | C. S + PTFE Lining | C. S + PTFE Lining |
| 663 | 1 | Bearing | C. S + PTFE Lining | C. S + PTFE Lining |
| 664 | 1 | Bearing | C. S + PTFE Lining | C. S + PTFE Lining |
| 700 | [*] | Spring | Alloy X 750 | Alloy X 750 |
| 701 | 1 | Anti-static spring | AISI 302 | AISI 302 |

Notes:

- [*] Quantity is according with valve size and pressure rating.
- For Stainless Steel (std. material), Refer to DB model.

FCT TRUNNION MOUNTED SPLIT BODY BALL VALVES

MODELS HPA, HRA, DB

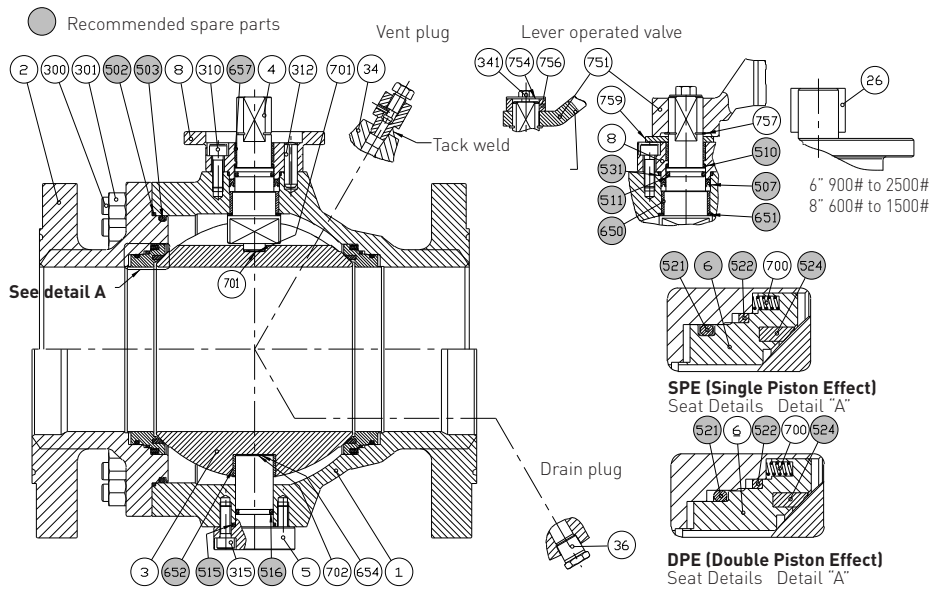

Valve size range:
6" to 8" FB
8" to 10" RB

Pressure Rating:
ANSI 150 to ANSI 2500

Note:

Ball and seat materials change according to the pressure rating

Valve part list with BOM – DB Model, soft seated, Class 150 to 600

| Item | Qty | Designation | Stainless Steel Standard Material | Notes |
|------|-----|--------------------|-----------------------------------|-------|
| 1 | 1 | Body | ASTM A 351 Gr. CF8M | |
| 2 | 1 | Body flange | ASTM A 351 Gr. CF8M | |
| 3 | 1 | Ball | ASTM A 182 Gr. F316 | |
| 4 | 1 | Stem | A 564 Gr. 630 [UNS S17400] | |
| 5 | 1 | Trunnion | A 564 Gr. 630 [UNS S17400] | |
| 6 | 2 | Seat ring | ASTM A 182 Gr. F316 | |
| 8 | 1 | Adaptor flange | ASTM A 182 Gr. F316 | |
| 26 | (*) | Shaft key | AISI 1048 | |
| 34 | 1 | Vent plug | ASTM A 182 Gr. F316 | |
| 36 | 1 | Drain plug | ASTM A 182 Gr. F316 | |
| 300 | (*) | Stud bolt | ASTM A 320 Gr. B8M Class 2 | |
| 301 | (*) | Nut | ASTM A 194 Gr. 8M | |
| 310 | (*) | Screw | ASTM A 320 Gr. B8M Class 2 | |
| 312 | 1 | Pin | ASTM A 182 Gr. F316 | |
| 315 | (*) | Screw | ASTM A 320 Gr. B8M Class 2 | |
| 341 | 1 | Screw | ASTM A 320 Gr. B8M Class 2 | [1] |
| 502 | 1 | Fire-safe gasket | Expanded Graphite | |
| 503 | 1 | O-ring seal | FKM | |
| 507 | 1 | Lip seal | PTFE + ELGILOY Spring | |
| 510 | 1 | Fire-safe gasket | Expanded Graphite | |
| 511 | 1 | O-ring seal | FKM | |
| 515 | 1 | Fire-safe gasket | Expanded Graphite | |
| 516 | 1 | O-ring seal | FKM | |
| 521 | 2 | O-ring seal | FKM | |
| 522 | 2 | Fire-safe gasket | Expanded Graphite | |
| 524 | 2 | Seat insert | PFA / PCTFE / Nylon | |
| 531 | 1 | Fire-safe gasket | Expanded Graphite | |
| 650 | 1 | Bearing | 316 SS + PTFE Lining | |
| 651 | 1 | Thrust washer | 316 SS + PTFE Lining | |
| 652 | 1 | Bearing | 316 SS + PTFE Lining | |
| 654 | 1 | Thrust washer | 316 SS + PTFE Lining | |
| 657 | 1 | Bearing | 316 SS + PTFE Lining | |
| 700 | (*) | Spring | Alloy X 750 | |
| 701 | 1 | Anti-static spring | AISI 316 | |
| 702 | 1 | Anti-static spring | AISI 316 | |
| 751 | 1 | Lever | C. S. Zinc Plated / Painted | [1] |
| 754 | 1 | Washer | C. S. Zinc Plated | [1] |
| 756 | 1 | Spacer | Stainless Steel | [1] |
| 757 | 1 | Stopper spring | Stainless Steel | [1] |
| 759 | 1 | Stop plate | AISI 1038 Zinc Plated | [1] |

Notes:

- (*) Quantity is according with valve size and pressure rating.
- (1) Only supplied on lever operated valves.
- For Carbon Steel (std. material), refer to HPA Model
- For Carbon Steel Body with stainless steel trim, refer to HPA Model

FCT TRUNNION MOUNTED SPLIT BODY BALL VALVES

MODELS HPA, HRA, DB

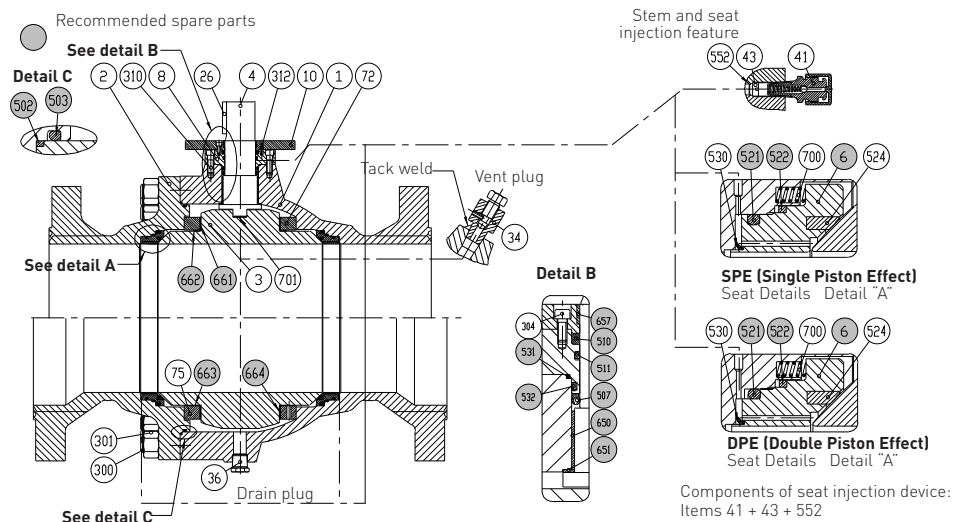

Valve size range:
10" to 24" FB
12" to 30" RB

Pressure Rating:
ANSI 150 to ANSI 600

Valve part list with BOM – DB Model, soft seated

| Item | Qty | Designation | Stainless Steel Standard Material |
|------|-----|---------------------------|--------------------------------------|
| 1 | 1 | Body | ASTM A 351 Gr. CF8M |
| 2 | 1 | Body flange | ASTM A 351 Gr. CF8M |
| 3 | 1 | Ball | ASTM A 182 Gr. F316 |
| 4 | 1 | Stem | A 564 Gr. 630 (UNS S17400) |
| 6 | 2 | Seat ring | ASTM A 182 Gr. F316 |
| 8 | 1 | Adaptor flange | ASTM A 182 Gr. F316 |
| 10 | 1 | Upper cap | ASTM A 182 Gr. F316 |
| 26 | (*) | Shaft key | AISI 4140 |
| 34 | 1 | Vent plug | ASTM A 182 Gr. F316 |
| 36 | 1 | Drain plug | ASTM A 182 Gr. F316 |
| 41 | (*) | Injection fitting | ASTM A 182 Gr. F316 |
| 43 | (*) | Mini check | ASTM A 182 Gr. F316 |
| 72 | 1 | Upper ball trunnion plate | AISI 316 |
| 75 | 1 | Lower ball trunnion plate | AISI 316 |
| 300 | (*) | Stud bolt | ASTM A 320 Gr. B8M Class 2 |
| 301 | (*) | Nut | ASTM A 194 Gr. 8M |
| 304 | (*) | Screw | ASTM A 320 Gr. B8M Class 2 |
| 310 | (*) | Screw | ASTM A 194 Gr. 8M |
| 312 | 2 | Pin | AISI 316 |
| 502 | 1 | Fire-safe gasket | Expanded Graphite |
| 503 | 1 | O-ring seal | FKM |
| 507 | 1 | Lip seal | PTFE + ELGILOY Spring |
| 510 | 1 | Fire-safe gasket | Expanded Graphite |
| 511 | 2 | O-ring seal | FKM |
| 521 | 2 | O-ring seal | FKM |
| 522 | 2 | Fire-safe gasket | Expanded Graphite |
| 524 | 2 | Seat insert | PFA / PCTFE / Nylon |
| 530 | 2 | Garter ring | PTFE |
| 531 | 1 | Fire-safe gasket | Expanded Graphite |
| 532 | 1 | O-ring seal | FKM |
| 552 | (*) | Gasket | PTFE |
| 650 | 1 | Bearing | 316 SS + PTFE Lining |
| 651 | 1 | Thrust washer | 316 SS + PTFE Lining |
| 657 | 1 | Bearing | 316 SS + PTFE Lining |
| 661 | 1 | Bearing | 316 SS + PTFE Lining |
| 662 | 1 | Bearing | 316 SS + PTFE Lining |
| 663 | 1 | Bearing | 316 SS + PTFE Lining |
| 664 | 1 | Bearing | 316 SS + PTFE Lining |
| 700 | (*) | Spring | Alloy X 750 |
| 701 | 1 | Anti-static spring | AISI 302 |

Notes:

(*) Quantity is according with valve size and pressure rating.

- For Carbon Steel (std. material) and Carbon Steel Body with stainless steel trim, refer to HPA Model

FCT TRUNNION MOUNTED SPLIT BODY BALL VALVES

MODELS HPA, HRA, DB

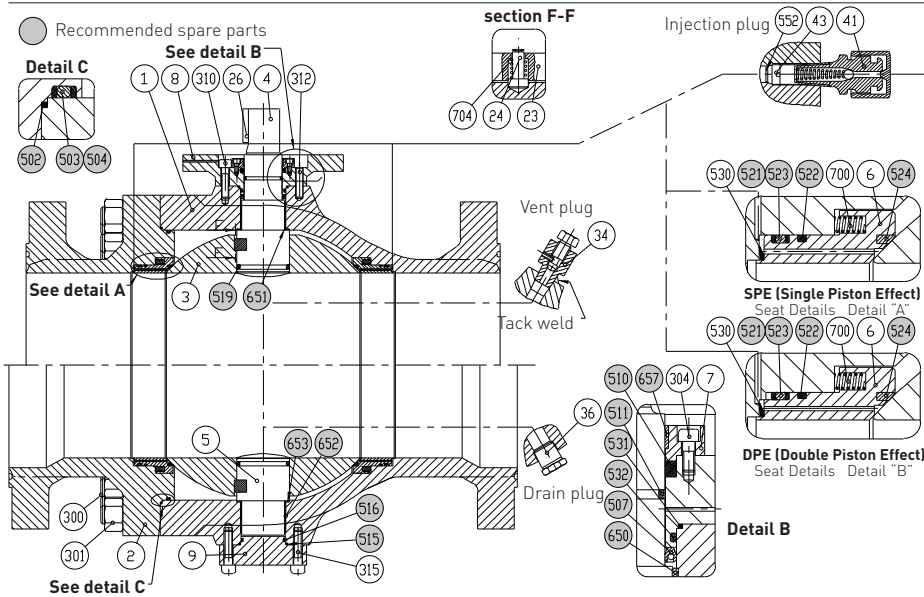

Valve size range:
26" to 60" FB
28" to 60" RB

Pressure Rating:
ANSI 150 to ANSI 2500

Note:
Ball and seat materials change according to the pressure rating

Valve part list with BOM – DB Model, soft seated, Class 150 to 600

| Item | Qty | Designation | Carbon Steel Standard Material | Carbon Steel Body with Stainless Steel trim | Stainless Steel Standard Material |
|------|-----|--------------------|-----------------------------------|--|--------------------------------------|
| 1 | 1 | Body | ASTM A 352 Gr. LCC | ASTM A 352 Gr. LCC | ASTM A 351 Gr. CF8M |
| 2 | 1 | Body flange | ASTM A 352 Gr. LCC | ASTM A 352 Gr. LCC | ASTM A 351 Gr. CF8M |
| 3 | 1 | Ball | ASTM A 350 Gr. LF2 +75µm ENP | ASTM A 182 Gr. F316 | ASTM A 182 Gr. F316 |
| 4 | 1 | Stem | A 276 Gr. UNS S41000 (AISI 410) | A 564 Gr. 630 (UNS S17400) | A 564 Gr. 630 (UNS S17400) |
| 5 | 1 | Trunnion | A 276 Gr. UNS S41000 (AISI 410) | A 564 Gr. 630 (UNS S17400) | A 564 Gr. 630 (UNS S17400) |
| 6 | 2 | Seat ring | A 276 Gr. UNS S41000 (AISI 410) | ASTM A 182 Gr. F316 | ASTM A 182 Gr. F316 |
| 7 | 1 | Cover | ASTM A 350 Gr. LF2 | ASTM A 350 Gr. LF2 | ASTM A 182 Gr. F316 |
| 8 | 1 | Adaptor flange | ASTM A 350 Gr. LF2 | ASTM A 350 Gr. LF2 | ASTM A 182 Gr. F316 |
| 9 | 1 | Lower cap | ASTM A 350 Gr. LF2 | ASTM A 350 Gr. LF2 | ASTM A 182 Gr. F316 |
| 23 | 2 | Ball key | ASTM A 182 Gr. F51 | ASTM A 182 Gr. F51 | A 564 Gr. 630 (UNS S17400) |
| 24 | 2 | Pin | ASTM A 182 Gr. F51 | ASTM A 182 Gr. F51 | A 564 Gr. 630 (UNS S17400) |
| 26 | (*) | Shaft key | AISI 1048 | AISI 1048 | AISI 1048 |
| 34 | 1 | Vent plug | ASTM A 350 Gr. LF2 | ASTM A 350 Gr. LF2 | ASTM A 182 Gr. F316 |
| 36 | 1 | Drain plug | ASTM A 350 Gr. LF2 | ASTM A 350 Gr. LF2 | ASTM A 182 Gr. F316 |
| 41 | (*) | Injection fitting | ASTM A 350 Gr. LF2 | ASTM A 350 Gr. LF2 | ASTM A 182 Gr. F316 |
| 43 | (*) | Mini check | ASTM A 182 Gr. F316 | ASTM A 182 Gr. F316 | ASTM A 182 Gr. F316 |
| 300 | (*) | Stud bolt | ASTM A 320 Gr. L7M | ASTM A 320 Gr. L7M | ASTM A 320 Gr. B8M Class 2 |
| 301 | (*) | Nut | ASTM A 194 Gr. 7M | ASTM A 194 Gr. 7M | ASTM A 194 Gr. 8M |
| 304 | (*) | Screw | ASTM A 320 Gr. L7M | ASTM A 320 Gr. L7M | ASTM A 320 Gr. B8M Class 2 |
| 310 | (*) | Screw | ASTM A 320 Gr. L7M | ASTM A 320 Gr. L7M | ASTM A 320 Gr. B8M Class 2 |
| 312 | (*) | Pin | AISI 1075 | AISI 1075 | AISI 316 |
| 315 | (*) | Screw | ASTM A 320 Gr. L7M | ASTM A 320 Gr. L7M | ASTM A 320 Gr. B8M Class 2 |
| 502 | 1 | Fire-safe gasket | Expanded Graphite | Expanded Graphite | Expanded Graphite |
| 503 | 1 | O-ring seal | FKM | FKM | FKM |
| 504 | 2 | Back-up ring | PCTFE / Nylon | PCTFE / Nylon | PCTFE / Nylon |
| 507 | 1 | Lip seal | PTFE + ELGILOY Spring | PTFE + ELGILOY Spring | PTFE + ELGILOY Spring |
| 510 | 1 | Fire-safe gasket | Expanded Graphite | Expanded Graphite | Expanded Graphite |
| 511 | 1 | O-ring seal | FKM | FKM | FKM |
| 515 | 1 | Fire-safe gasket | Expanded Graphite | Expanded Graphite | Expanded Graphite |
| 516 | 1 | O-ring seal | FKM | FKM | FKM |
| 519 | 2 | O-ring seal | FKM | FKM | FKM |
| 521 | 2 | O-ring seal | FKM | FKM | FKM |
| 522 | 2 | Fire-safe gasket | Expanded Graphite | Expanded Graphite | Expanded Graphite |
| 523 | 4 | Back-up ring | PCTFE / Nylon | PCTFE / Nylon | PCTFE / Nylon |
| 524 | 2 | Seat insert | PFA / PCTFE / Nylon | PFA / PCTFE / Nylon | PFA / PCTFE / Nylon |
| 530 | 2 | Garther ring | PTFE | PTFE | PTFE |
| 531 | 1 | Fire-safe gasket | Expanded Graphite | Expanded Graphite | Expanded Graphite |
| 532 | 1 | O-ring seal | FKM | FKM | FKM |
| 552 | (*) | Gasket | PTFE | PTFE | PTFE |
| 650 | 1 | Bearing | C. S + PTFE Lining | C. S + PTFE Lining | 316 SS + PTFE Lining |
| 651 | 1 | Thrust washer | C. S + PTFE Lining | C. S + PTFE Lining | 316 SS + PTFE Lining |
| 652 | 1 | Bearing | C. S + PTFE Lining | C. S + PTFE Lining | 316 SS + PTFE Lining |
| 653 | 1 | Thrust washer | C. S + PTFE Lining | C. S + PTFE Lining | 316 SS + PTFE Lining |
| 657 | 1 | Bearing | C. S + PTFE Lining | C. S + PTFE Lining | 316 SS + PTFE Lining |
| 700 | (*) | Spring | Alloy X 750 | Alloy X 750 | Alloy X 750 |
| 704 | 2 | Anti-static spring | Alloy X 750 | Alloy X 750 | Alloy X 750 |

Note:
[*] Quantity is according with valve size and pressure rating.

FCT TRUNNION MOUNTED SPLIT BODY BALL VALVES

MODELS HPA, HRA, DB

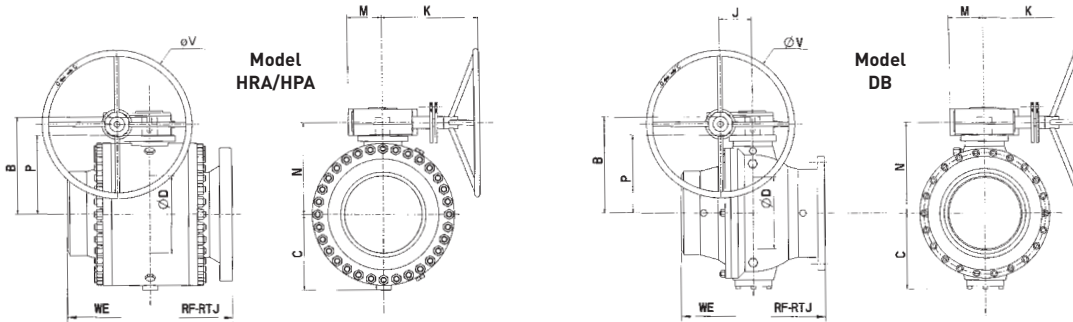

Dimensions ANSI 150 – Full Bore 2" to 60" – Reduced Bore 3" to 60" – Models HRA, HPA and DB

| Nominal Diameter | in. [mm] | RF | RJ | WE | B | C | D | J | K | L(3) | M | N | P | V | Weight lb. | | | |
|------------------|----------|----|-------|-------|--------|-------|-------|-------|-------|-------|-------|-------|-------|-------|------------|--------|---------------|-------|
| | | | | | | | | | | | | | | | RF-RTJ | WE | Gear operator | |
| 2" | [50] | FB | 7,01 | 7,52 | 8,50 | 5,04 | 3,43 | 2,01 | (1) | (1) | 14,57 | (1) | 6,38 | 4,06 | (1) | 46 | 83 | (1) |
| 3" | | RB | 7,99 | 8,50 | 11,14 | 5,04 | 3,43 | 2,01 | (1) | (1) | 14,57 | (1) | 6,38 | 4,06 | (1) | 57 | 83 | (1) |
| | [80] | FB | 7,99 | 8,50 | 11,14 | 5,91 | 4,49 | 2,99 | (1) | (1) | 14,57 | (1) | 7,13 | 4,80 | (1) | 84 | 141 | (1) |
| 4" | | RB | 9,02 | 9,49 | 12,01 | 5,91 | 4,49 | 2,99 | (1) | (1) | 14,57 | (1) | 7,13 | 4,80 | (1) | 95 | 156 | (1) |
| | [100] | FB | 9,02 | 9,49 | 12,01 | 7,24 | 5,04 | 4,02 | (1) | (1) | 19,69 | (1) | 7,17 | 5,91 | (1) | 110 | 190 | (1) |
| 6" | | RB | 15,51 | 15,98 | 17,99 | 7,24 | 5,04 | 4,02 | (1) | (1) | 19,69 | (1) | 7,17 | 5,91 | (1) | 161 | 277 | (1) |
| | [150] | FB | 15,51 | 15,98 | 17,99 | 9,49 | 7,28 | 5,98 | (1) | (1) | 35,43 | (1) | 9,29 | 7,91 | (1) | 331 | 651 | (1) |
| 8" | | RB | 17,99 | 18,50 | 20,51 | 9,49 | 7,28 | 5,98 | (1) | (1) | 35,43 | (1) | 9,29 | 7,91 | (1) | 386 | 729 | (1) |
| | [200] | FB | 17,99 | 18,50 | 20,51 | 12,09 | 9,29 | 7,99 | 2,64 | 10,00 | (2) | 2,95 | 11,22 | 9,57 | 17,99 | 639 | 1.288 | 26 |
| 10" | | RB | 20,98 | 21,50 | 22,01 | 12,09 | 9,29 | 7,99 | 2,64 | 10,00 | (2) | 2,95 | 11,22 | 9,57 | 17,99 | 728 | 1.434 | 26 |
| | [250] | FB | 20,98 | 21,50 | 22,01 | 13,35 | 9,25 | 10,00 | 3,54 | 10,67 | (2) | 3,90 | 12,91 | 10,94 | 17,99 | 838 | 1.677 | 40 |
| 12" | | RB | 24,02 | 24,49 | 25,00 | 13,35 | 9,25 | 10,00 | 3,54 | 10,67 | (2) | 3,90 | 12,91 | 10,94 | 17,99 | 970 | 1.886 | 40 |
| | [300] | FB | 24,02 | 24,49 | 25,00 | 15,94 | 11,02 | 12,01 | 4,84 | 13,23 | (2) | 4,96 | 15,04 | 13,07 | 17,99 | 1.279 | 2.566 | 71 |
| 14" | | RB | 27,01 | 27,52 | 30,00 | 15,94 | 11,02 | 12,01 | 4,84 | 13,23 | (2) | 4,96 | 15,04 | 13,07 | 17,99 | 1.422 | 2.795 | 71 |
| | [350] | FB | 27,01 | 27,52 | 30,00 | 17,83 | 12,17 | 13,27 | 4,84 | 14,61 | (2) | 4,96 | 16,14 | 14,17 | 24,02 | 1.720 | 3.451 | 71 |
| 16" | | RB | 30,00 | 30,51 | 32,99 | 17,83 | 12,17 | 13,27 | 4,84 | 14,61 | (2) | 4,96 | 16,14 | 14,17 | 24,02 | 1.940 | 3.854 | 71 |
| | [400] | FB | 30,00 | 30,51 | 32,99 | 19,33 | 13,58 | 15,24 | 4,84 | 16,02 | (2) | 4,96 | 17,64 | 15,67 | 30,00 | 2.271 | 4.583 | 75 |
| 18" | | RB | 34,02 | 34,49 | 35,98 | 19,33 | 13,58 | 15,24 | 4,84 | 16,02 | (2) | 4,96 | 17,64 | 15,67 | 30,00 | 2.513 | 5.079 | 75 |
| | [450] | FB | 34,02 | 34,49 | 35,98 | 22,36 | 15,47 | 17,24 | 6,06 | 17,01 | (2) | 6,22 | 19,76 | 17,80 | 30,00 | 3.197 | 6.586 | 106 |
| 20" | | RB | 35,98 | 36,50 | 39,02 | 22,36 | 15,47 | 17,24 | 6,06 | 17,01 | (2) | 6,22 | 19,76 | 17,80 | 30,00 | 3.439 | 6.994 | 106 |
| | [500] | FB | 35,98 | 36,50 | 39,02 | 24,02 | 17,05 | 19,25 | 2,36 | 21,18 | (2) | 6,10 | 22,05 | 19,45 | 30,00 | 3.968 | 8.161 | 150 |
| 22" | | RB | 40,98 | 41,50 | 42,99 | 24,02 | 17,05 | 19,25 | 2,36 | 21,18 | (2) | 6,10 | 22,05 | 19,45 | 30,00 | 4.211 | 8.579 | 150 |
| | [550] | FB | 40,98 | 41,50 | 42,99 | 26,22 | 18,98 | 21,26 | 3,82 | 19,45 | (2) | 7,01 | 25,35 | 21,42 | 17,99 | 5.071 | 10.474 | 229 |
| 24" | | RB | 42,01 | 42,52 | 45,00 | 26,22 | 18,98 | 21,26 | 3,82 | 19,45 | (2) | 7,01 | 25,35 | 21,42 | 17,99 | 5.512 | 11.329 | 229 |
| | [600] | FB | 42,01 | 42,52 | 45,00 | 27,76 | 20,51 | 23,27 | 3,82 | 19,61 | (2) | 7,01 | 26,69 | 22,95 | 17,99 | 6.217 | 12.151 | 229 |
| 26" | | RB | 45,00 | 45,98 | 49,02 | 27,76 | 20,51 | 23,27 | 3,82 | 19,61 | (2) | 7,01 | 26,69 | 22,95 | 17,99 | 6.504 | 13.011 | 229 |
| | [650] | FB | 45,00 | 45,98 | 49,02 | 30,47 | 23,03 | 25,00 | 2,13 | 18,39 | (2) | 6,10 | 27,76 | 25,16 | 17,99 | 7.385 | 14.955 | 143 |
| 28" | | RB | 49,02 | 50,00 | 52,99 | 30,47 | 23,03 | 25,00 | 2,13 | 18,39 | (2) | 6,10 | 27,76 | 25,16 | 17,99 | 7.804 | 15.689 | 143 |
| | [700] | FB | 49,02 | 50,00 | 52,99 | 32,01 | 24,57 | 27,01 | 2,13 | 21,18 | (2) | 6,10 | 29,29 | 26,69 | 30,00 | 9.326 | 19.043 | 148 |
| 30" | | RB | 50,98 | 52,01 | 55,00 | 32,01 | 24,57 | 27,01 | 2,13 | 21,18 | (2) | 6,10 | 29,29 | 26,69 | 30,00 | 9.921 | 20.122 | 148 |
| | [750] | FB | 50,98 | 52,01 | 55,00 | 33,66 | 27,91 | 29,02 | 3,82 | 20,59 | (2) | 7,01 | 30,94 | 28,35 | 24,02 | 11.623 | 23.874 | 220 |
| 32" | | RB | 54,02 | 55,12 | 60,00 | 33,66 | 27,91 | 29,02 | 3,70 | 20,59 | (2) | 7,01 | 30,94 | 28,35 | 24,02 | 12.125 | 24.472 | 220 |
| | [800] | FB | 54,02 | 55,12 | 60,00 | 35,43 | 28,74 | 30,75 | 9,33 | 21,65 | (2) | 9,13 | 33,07 | 30,31 | 14,37 | 13.558 | 27.631 | 395 |
| 34" | | RB | 57,99 | 59,13 | 64,02 | 35,43 | 28,74 | 30,75 | 9,33 | 21,65 | (2) | 9,13 | 33,07 | 30,31 | 14,37 | 14.550 | 29.663 | 395 |
| | [850] | FB | 57,99 | 59,13 | 64,02 | 37,40 | 29,92 | 32,76 | 3,82 | 23,31 | (2) | 7,01 | 34,45 | 31,89 | 35,98 | 15.873 | 32.579 | 260 |
| 36" | | RB | 60,00 | 61,10 | 67,99 | 37,40 | 29,92 | 32,76 | 3,82 | 23,31 | (2) | 7,01 | 34,45 | 31,89 | 35,98 | 16.976 | 34.484 | 260 |
| | [900] | FB | 60,00 | 61,10 | 67,99 | 38,35 | 31,38 | 34,49 | 9,33 | 22,91 | (2) | 9,13 | 35,83 | 33,07 | 17,99 | 18.210 | 37.206 | 401 |
| 40" | | RB | 67,01 | - | 76,77 | 38,35 | 31,38 | 34,49 | 9,33 | 22,91 | (2) | 9,13 | 35,83 | 33,07 | 17,99 | 19.886 | 40.355 | 401 |
| | [1000] | FB | 67,01 | - | 76,77 | 41,73 | 34,06 | 38,50 | 9,33 | 24,29 | (2) | 9,13 | 38,58 | 35,83 | 24,02 | 23.611 | 48.569 | 401 |
| 42" | | RB | 73,23 | - | 79,33 | 41,73 | 34,06 | 38,50 | 9,33 | 24,29 | (2) | 9,13 | 38,58 | 35,83 | 24,02 | 26.235 | 53.746 | 401 |
| | [1050] | FB | 73,23 | - | 79,33 | 43,70 | 35,83 | 40,24 | 9,33 | 24,29 | (2) | 9,13 | 40,55 | 37,80 | 24,02 | 27.778 | 57.148 | 401 |
| 48" | | RB | 87,99 | - | 87,40 | 43,70 | 35,83 | 40,24 | 9,33 | 24,29 | (2) | 9,13 | 40,55 | 37,80 | 24,02 | 29.696 | 60.006 | 401 |
| | [1200] | FB | 87,99 | - | 87,40 | 50,39 | 40,16 | 45,98 | 9,33 | 25,71 | (2) | 9,13 | 46,06 | 43,31 | 30,00 | 37.258 | 76.677 | 406 |
| 56" | | RB | 88,58 | - | 98,43 | 50,39 | 40,16 | 45,98 | 9,33 | 25,71 | (2) | 9,13 | 46,06 | 43,31 | 30,00 | 41.888 | 84.356 | 406 |
| | [1400] | FB | 88,58 | - | 98,43 | 54,72 | 45,28 | 53,74 | 14,02 | 40,47 | (2) | 14,02 | 51,89 | 47,24 | 24,02 | 45.889 | 93.178 | 1.574 |
| 60" | | RB | 94,49 | - | 103,94 | 54,72 | 45,28 | 53,74 | 14,02 | 40,47 | (2) | 14,02 | 51,89 | 47,24 | 24,02 | 52.911 | 107.297 | 1.574 |
| | [1500] | FB | 94,49 | - | 103,94 | 60,83 | 50,39 | 57,52 | 14,02 | 41,89 | (2) | 14,02 | 55,83 | 51,18 | 30,00 | 59.999 | 122.923 | 1.579 |

Standards do not exist for these dimensions - Contact your sales representative.

RB = Reduced Bore
FB = Full Bore

- (1) Lever operated valves
- (2) Gear operated valves
- (3) "L" dimension not shown on sketches is lever length dimension

All measurements and weights are representative of typical model designation; however, actual may vary depending on selection of model, base material, cast or forged design and end connections. Please contact your local sales representative for further clarification.

FCT TRUNNION MOUNTED SPLIT BODY BALL VALVES

MODELS HPA, HRA, DB

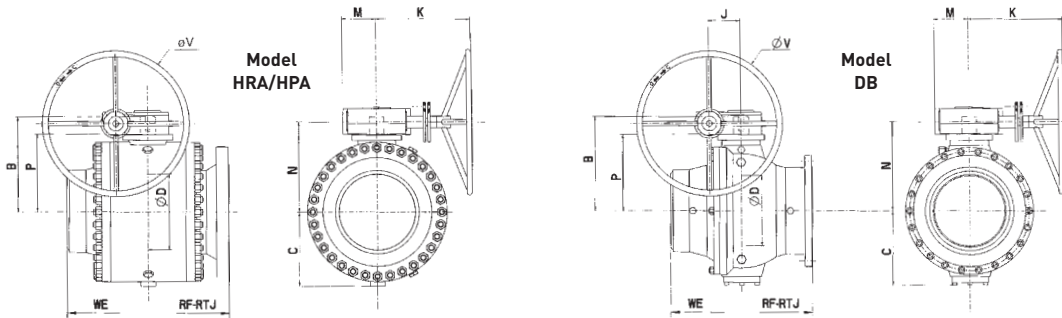

Dimensions ANSI 300 – Full Bore 2" to 60" – Reduced Bore 3" to 60" – Models HRA, HPA and DB

| Nominal Diameter | in. [mm] | RF | RJ | WE | B | C | D | J | K | L(3) | M | N | P | V | Weight lb. | | | |
|------------------|----------|----|-------|-------|--------|-------|-------|-------|-------|---------|-------|-------|-------|-------|------------|--------|---------------|-------|
| | | | | | | | | | | | | | | | RF-RTJ | WE | Gear operator | |
| 2" | [50] | FB | 8,50 | 9,13 | 8,50 | 5,04 | 3,43 | 2,01 | (1) | (1) | 14,57 | (1) | 6,38 | 4,06 | (1) | 49 | 35 | (1) |
| 3" | | RB | 11,14 | 11,73 | 11,14 | 5,04 | 3,43 | 2,01 | (1) | (1) | 14,57 | (1) | 6,38 | 4,06 | (1) | 68 | 42 | (1) |
| | [80] | FB | 11,14 | 11,73 | 11,14 | 5,91 | 4,49 | 2,83 | (1) | (1) | 14,57 | (1) | 7,13 | 4,80 | (1) | 90 | 64 | (1) |
| 4" | | RB | 12,01 | 12,64 | 12,01 | 5,91 | 4,49 | 2,83 | (1) | (1) | 14,57 | (1) | 7,13 | 4,80 | (1) | 119 | 75 | (1) |
| | [100] | FB | 12,01 | 12,64 | 12,01 | 7,24 | 5,04 | 4,02 | (1) | (1) | 19,69 | (1) | 7,17 | 5,91 | (1) | 143 | 99 | (1) |
| 6" | | RB | 15,87 | 16,50 | 17,99 | 7,24 | 5,04 | 4,02 | (1) | (1) | 19,69 | (1) | 7,17 | 5,91 | (1) | 201 | 130 | (1) |
| | [150] | FB | 15,87 | 16,50 | 17,99 | 9,49 | 7,28 | 5,98 | 7,36 | 187,00 | (2) | 2,28 | 9,29 | 7,91 | 300 | 375 | 304 | 13 |
| 8" | | RB | 19,76 | 20,39 | 20,51 | 9,49 | 7,28 | 5,98 | 7,36 | 187,00 | (2) | 2,28 | 9,29 | 7,91 | 300 | 465 | 357 | 13 |
| | [200] | FB | 19,76 | 20,39 | 20,51 | 12,09 | 9,29 | 7,99 | 11,38 | 289,00 | (2) | 2,95 | 11,22 | 9,57 | 610 | 683 | 575 | 26 |
| 10" | | RB | 22,36 | 22,99 | 22,01 | 12,09 | 9,29 | 7,99 | 11,38 | 289,00 | (2) | 2,95 | 11,22 | 9,57 | 610 | 816 | 659 | 26 |
| | [250] | FB | 22,36 | 22,99 | 22,01 | 13,35 | 9,25 | 10,00 | 12,05 | 306,00 | (2) | 3,90 | 13,31 | 10,94 | 610 | 904 | 747 | 46 |
| 12" | | RB | 25,51 | 26,14 | 25,00 | 13,35 | 9,25 | 10,00 | 12,05 | 306,00 | (2) | 3,90 | 13,31 | 10,94 | 610 | 1.058 | 836 | 46 |
| | [300] | FB | 25,51 | 26,14 | 25,00 | 15,94 | 11,02 | 12,01 | 16,02 | 407,00 | (2) | 4,96 | 15,43 | 13,07 | 762 | 1.455 | 1.232 | 110 |
| 14" | | RB | 30,00 | 30,63 | 30,00 | 15,94 | 11,02 | 12,01 | 16,02 | 407,00 | (2) | 4,96 | 15,43 | 13,07 | 762 | 1.742 | 1.409 | 110 |
| | [350] | FB | 30,00 | 30,63 | 30,00 | 17,83 | 12,17 | 12,01 | 17,01 | 432,00 | (2) | 6,22 | 16,77 | 14,17 | 762 | 2.039 | 1.706 | 143 |
| 16" | | RB | 32,99 | 33,62 | 32,99 | 17,83 | 12,17 | 12,01 | 17,01 | 432,00 | (2) | 6,22 | 16,77 | 14,17 | 762 | 2.238 | 1.858 | 143 |
| | [400] | FB | 32,99 | 33,62 | 32,99 | 19,33 | 13,58 | 15,24 | 21,18 | 538,00 | (2) | 5,67 | 18,27 | 15,67 | 762 | 2.668 | 2.288 | 150 |
| 18" | | RB | 35,98 | 36,61 | 35,98 | 19,33 | 13,58 | 15,24 | 21,18 | 538,00 | (2) | 5,67 | 18,27 | 15,67 | 762 | 2.965 | 2.498 | 150 |
| | [450] | FB | 35,98 | 36,61 | 35,98 | 22,36 | 15,47 | 17,24 | 21,18 | 538,00 | (2) | 6,10 | 20,35 | 17,80 | 762 | 3.748 | 3.280 | 150 |
| 20" | | RB | 39,02 | 39,76 | 39,02 | 22,36 | 15,47 | 17,24 | 21,18 | 538,00 | (2) | 6,10 | 20,35 | 17,80 | 762 | 4.189 | 3.618 | 150 |
| | [500] | FB | 39,02 | 39,76 | 39,02 | 24,02 | 17,05 | 19,25 | 18,39 | 467,00 | (2) | 6,10 | 22,01 | 19,45 | 457 | 4.674 | 4.103 | 245 |
| 22" | | RB | 42,99 | 43,86 | 42,99 | 24,02 | 17,05 | 19,25 | 18,39 | 467,00 | (2) | 6,10 | 22,01 | 19,45 | 457 | 4.916 | 4.211 | 245 |
| | [550] | FB | 42,99 | 43,86 | 42,99 | 26,22 | 18,98 | 21,26 | 19,76 | 502,00 | (2) | 6,10 | 23,98 | 21,42 | 610 | 6.107 | 5.401 | 245 |
| 24" | | RB | 45,00 | 45,87 | 45,00 | 26,22 | 18,98 | 21,26 | 19,76 | 502,00 | (2) | 6,10 | 23,98 | 21,42 | 610 | 6.305 | 5.459 | 245 |
| | [600] | FB | 45,00 | 45,87 | 45,00 | 27,76 | 20,51 | 23,27 | 22,20 | 564,00 | (2) | 7,01 | 25,71 | 22,95 | 457 | 7.143 | 6.296 | 419 |
| 26" | | RB | 49,02 | 50,00 | 49,02 | 27,76 | 20,51 | 23,27 | 22,20 | 564,00 | (2) | 7,01 | 25,71 | 22,95 | 457 | 7.937 | 6.892 | 419 |
| | [650] | FB | 49,02 | 50,00 | 49,02 | 30,47 | 23,03 | 25,00 | 23,58 | 599,00 | (2) | 7,01 | 27,72 | 25,16 | 610 | 9.921 | 8.876 | 419 |
| 28" | | RB | 52,99 | 54,02 | 52,99 | 30,47 | 23,03 | 25,00 | 23,58 | 599,00 | (2) | 7,01 | 27,72 | 25,16 | 610 | 10.582 | 9.310 | 419 |
| | [700] | FB | 52,99 | 54,02 | 52,99 | 32,01 | 26,61 | 27,01 | 23,58 | 599,00 | (2) | 7,01 | 31,26 | 26,69 | 610 | 11.299 | 10.027 | 419 |
| 30" | | RB | 55,00 | 55,98 | 55,00 | 32,01 | 26,61 | 27,01 | 23,58 | 599,00 | (2) | 7,01 | 31,26 | 26,69 | 610 | 11.684 | 10.223 | 419 |
| | [750] | FB | 55,00 | 55,98 | 55,00 | 33,66 | 29,92 | 29,02 | 24,29 | 617,00 | (2) | 9,13 | 31,10 | 28,35 | 610 | 12.787 | 11.325 | 419 |
| 32" | | RB | 60,00 | 61,14 | 60,00 | 33,66 | 29,92 | 29,02 | 24,29 | 617,00 | (2) | 9,13 | 31,10 | 28,35 | 610 | 13.889 | 12.181 | 419 |
| | [800] | FB | 60,00 | 61,14 | 60,00 | 35,43 | 31,10 | 30,75 | 24,29 | 617,00 | (2) | 9,13 | 33,07 | 30,31 | 610 | 15.432 | 13.724 | 419 |
| 34" | | RB | 64,02 | 65,12 | 64,02 | 35,43 | 31,10 | 30,75 | 24,29 | 617,00 | (2) | 9,13 | 33,07 | 30,31 | 610 | 16.314 | 14.407 | 419 |
| | [850] | FB | 64,02 | 65,12 | 64,02 | 37,40 | 32,09 | 32,76 | 24,29 | 617,00 | (2) | 9,13 | 34,65 | 31,89 | 610 | 18.078 | 16.171 | 419 |
| 36" | | RB | 67,99 | 69,13 | 67,99 | 37,40 | 32,09 | 32,76 | 24,29 | 617,00 | (2) | 9,13 | 34,65 | 31,89 | 610 | 18.960 | 16.821 | 419 |
| | [900] | FB | 67,99 | 69,13 | 67,99 | 38,35 | 32,48 | 34,49 | 25,71 | 653,00 | (2) | 9,13 | 35,83 | 33,07 | 762 | 20.283 | 18.144 | 419 |
| 40" | | RB | 75,00 | - | 76,77 | 38,35 | 32,48 | 34,49 | 25,71 | 653,00 | (2) | 9,13 | 35,83 | 33,07 | 762 | 21.605 | 19.983 | 419 |
| | [1000] | FB | 75,00 | - | 76,77 | 41,73 | 36,42 | 38,50 | 27,13 | 689,00 | (2) | 9,13 | 38,58 | 35,83 | 914 | 26.037 | 24.414 | 432 |
| 42" | | RB | 75,98 | - | 79,33 | 41,73 | 36,42 | 38,50 | 27,13 | 689,00 | (2) | 9,13 | 38,58 | 35,83 | 914 | 26.676 | 24.884 | 432 |
| | [1050] | FB | 75,98 | - | 79,33 | 43,70 | 38,19 | 40,24 | 28,43 | 722,00 | (2) | 11,14 | 41,06 | 37,80 | 457 | 30.424 | 28.631 | 619 |
| 48" | | RB | 87,99 | - | 87,40 | 43,70 | 38,19 | 40,24 | 28,43 | 722,00 | (2) | 11,14 | 41,06 | 37,80 | 457 | 33.069 | 30.516 | 619 |
| | [1200] | FB | 87,99 | - | 87,40 | 50,39 | 41,81 | 45,98 | 28,43 | 722,00 | (2) | 11,14 | 46,57 | 43,31 | 457 | 39.463 | 36.910 | 611 |
| 56" | | RB | 90,55 | - | 98,43 | 50,39 | 41,81 | 45,98 | 28,43 | 722,00 | (2) | 11,14 | 46,57 | 43,31 | 457 | 45.195 | 41.215 | 611 |
| | [1400] | FB | 90,55 | - | 98,43 | 54,72 | 47,64 | 53,74 | 41,89 | 1064,00 | (2) | 14,02 | 44,61 | 47,24 | 762 | 51.654 | 47.675 | 1.579 |
| 60" | | RB | 94,49 | - | 103,94 | 54,72 | 47,64 | 53,74 | 41,89 | 1064,00 | (2) | 14,02 | 44,61 | 47,24 | 762 | 58.290 | 53.744 | 1.579 |
| | [1500] | FB | 94,49 | - | 103,94 | 60,83 | 52,76 | 57,52 | 42,95 | 1091,00 | (2) | 14,02 | 50,12 | 51,18 | 914 | 66.580 | 62.034 | 1.605 |

Standards do not exist for these dimensions - Contact your sales representative.

RB = Reduced Bore
FB = Full Bore

- (1) Lever operated valves
- (2) Gear operated valves
- (3) "L" dimension not shown on sketches is lever length dimension

All measurements and weights are representative of typical model designation; however, actual may vary depending on selection of model, base material, cast or forged design and end connections. Please contact your local sales representative for further clarification.

FCT TRUNNION MOUNTED SPLIT BODY BALL VALVES

MODELS HPA, HRA, DB

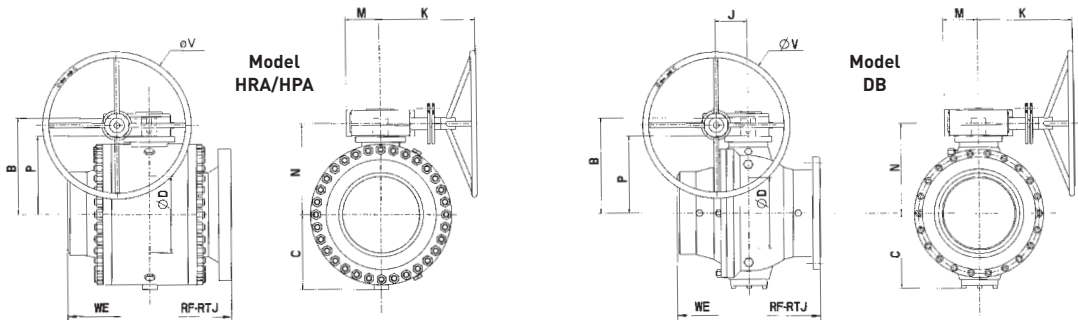

Dimensions ANSI 600 – Full Bore 2" to 60" – Reduced Bore 3" to 60" – Models HRA, HPA and DB

| ANSI 600 | Nominal Diameter in. [mm] | RF | RJ | WE | B | C | D | J | K | L(3) | M | N | P | V | Weight lb. | | |
|----------|------------------------------|--------|-------|--------|-------|-------|-------|-------|-------|-------|-------|-------|-------|-------|------------|--------|---------------|
| | | | | | | | | | | | | | | | RF-RTJ | WE | Gear operator |
| | | | | | | | | | | | | | | | | | |
| 2" [50] | FB | 11,50 | 11,61 | 11,50 | 6,30 | 3,43 | 2,01 | (1) | (1) | 14,57 | (1) | 6,38 | 4,06 | (1) | 55 | 40 | (1) |
| 3" | RB | 14,02 | 14,13 | 14,02 | 6,30 | 3,43 | 2,01 | (1) | (1) | 14,57 | (1) | 6,38 | 4,06 | (1) | 77 | 49 | (1) |
| [80] | FB | 14,02 | 14,13 | 14,02 | 7,28 | 4,49 | 2,99 | (1) | (1) | 14,57 | (1) | 7,48 | 5,12 | (1) | 123 | 95 | (1) |
| 4" | RB | 17,01 | 17,13 | 17,01 | 7,28 | 4,49 | 2,99 | (1) | (1) | 14,57 | (1) | 7,48 | 5,12 | (1) | 168 | 106 | (1) |
| [100] | FB | 17,01 | 17,13 | 17,01 | 7,68 | 5,75 | 4,02 | (1) | (1) | 35,43 | (1) | 7,76 | 6,38 | (1) | 243 | 181 | (1) |
| 6" | RB | 22,01 | 22,13 | 22,01 | 7,68 | 5,75 | 4,02 | (1) | (1) | 35,43 | (1) | 7,76 | 6,38 | (1) | 348 | 227 | (1) |
| [150] | FB | 22,01 | 22,13 | 22,01 | 10,24 | 7,87 | 5,98 | 2,64 | 10,00 | (2) | 2,95 | 9,76 | 8,11 | 17,99 | 551 | 430 | 26 |
| 8" | RB | 25,98 | 26,14 | 25,98 | 10,24 | 7,87 | 5,98 | 2,64 | 10,00 | (2) | 2,95 | 9,76 | 8,11 | 17,99 | 683 | 498 | 26 |
| [200] | FB | 25,98 | 26,14 | 25,98 | 12,32 | 9,72 | 7,99 | 3,54 | 12,05 | (2) | 3,90 | 11,77 | 9,80 | 24,02 | 948 | 763 | 42 |
| 10" | RB | 30,98 | 31,14 | 30,98 | 12,32 | 9,72 | 7,99 | 3,54 | 12,05 | (2) | 3,90 | 11,77 | 9,80 | 24,02 | 1.168 | 869 | 42 |
| [250] | FB | 30,98 | 31,14 | 30,98 | 14,72 | 9,88 | 10,00 | 4,84 | 16,02 | (2) | 4,96 | 14,02 | 11,85 | 30,00 | 1.433 | 1.133 | 110 |
| 12" | RB | 32,99 | 33,11 | 32,99 | 14,72 | 9,88 | 10,00 | 4,84 | 16,02 | (2) | 4,96 | 14,02 | 11,85 | 30,00 | 1.565 | 1.213 | 110 |
| [300] | FB | 32,99 | 33,11 | 32,99 | 17,20 | 11,57 | 12,01 | 2,13 | 19,76 | (2) | 5,67 | 15,75 | 13,54 | 24,02 | 2.061 | 1.709 | 150 |
| 14" | RB | 35,00 | 35,12 | 35,00 | 17,20 | 11,57 | 12,01 | 2,13 | 19,76 | (2) | 5,67 | 15,75 | 13,54 | 24,02 | 2.205 | 1.784 | 150 |
| [350] | FB | 35,00 | 35,12 | 35,00 | 18,62 | 13,11 | 13,27 | 2,13 | 21,18 | (2) | 6,10 | 17,99 | 14,76 | 30,00 | 2.822 | 2.401 | 150 |
| 16" | RB | 39,02 | 39,13 | 39,02 | 18,62 | 13,11 | 13,27 | 2,13 | 21,18 | (2) | 6,10 | 17,99 | 14,76 | 30,00 | 3.329 | 2.736 | 150 |
| [400] | FB | 39,02 | 39,13 | 39,02 | 21,18 | 14,41 | 15,24 | 5,43 | 23,58 | (2) | 6,10 | 20,59 | 16,61 | 24,02 | 3.660 | 3.067 | 256 |
| 18" | RB | 42,99 | 43,11 | 42,99 | 21,18 | 14,41 | 15,24 | 5,43 | 23,58 | (2) | 6,10 | 20,59 | 16,61 | 24,02 | 4.145 | 3.426 | 256 |
| [450] | FB | 42,99 | 43,11 | 42,99 | 23,31 | 16,26 | 17,24 | 7,13 | 22,20 | (2) | 7,01 | 22,48 | 18,50 | 17,99 | 5.071 | 4.352 | 256 |
| 20" | RB | 47,01 | 47,24 | 47,01 | 23,31 | 16,26 | 17,24 | 7,13 | 22,20 | (2) | 7,01 | 22,48 | 18,50 | 17,99 | 5.776 | 4.872 | 256 |
| [500] | FB | 47,01 | 47,24 | 47,01 | 25,43 | 18,35 | 19,25 | 7,13 | 23,58 | (2) | 7,01 | 25,04 | 20,63 | 24,02 | 6.614 | 5.710 | 419 |
| 22" | RB | 50,98 | 51,38 | 50,98 | 25,43 | 18,35 | 19,25 | 7,13 | 23,58 | (2) | 7,01 | 25,04 | 20,63 | 24,02 | 7.055 | 5.930 | 419 |
| [550] | FB | 50,98 | 51,38 | 50,98 | 26,46 | 20,04 | 21,26 | 9,33 | 24,25 | (2) | 9,13 | 26,85 | 22,44 | 24,02 | 8.863 | 7.520 | 419 |
| 24" | RB | 55,00 | 55,39 | 55,00 | 26,46 | 20,04 | 21,26 | 9,33 | 24,25 | (2) | 9,13 | 26,85 | 22,44 | 24,02 | 8.863 | 7.520 | 419 |
| [600] | FB | 55,00 | 55,39 | 55,00 | 29,76 | 21,93 | 23,27 | 9,33 | 24,45 | (2) | 9,13 | 28,31 | 23,90 | 24,02 | 10.141 | 8.799 | 419 |
| 26" | RB | 57,01 | 57,52 | 57,01 | 29,76 | 21,93 | 23,27 | 9,33 | 24,45 | (2) | 9,13 | 28,31 | 23,90 | 24,02 | 10.847 | 9.215 | 419 |
| [650] | FB | 57,01 | 57,52 | 57,01 | 33,86 | 25,04 | 25,00 | 9,33 | 24,45 | (2) | 9,13 | 30,08 | 27,32 | 24,02 | 12.081 | 10.450 | 419 |
| 28" | RB | 60,98 | 61,50 | 60,98 | 33,86 | 25,04 | 25,00 | 9,33 | 24,45 | (2) | 9,13 | 30,08 | 27,32 | 24,02 | 12.699 | 10.886 | 419 |
| [700] | FB | 60,98 | 61,50 | 60,98 | 35,43 | 26,61 | 27,01 | 9,33 | 27,13 | (2) | 9,13 | 31,65 | 28,90 | 17,99 | 14.584 | 12.771 | 434 |
| 30" | RB | 65,00 | 65,51 | 65,00 | 35,43 | 26,61 | 27,01 | 9,33 | 27,13 | (2) | 9,13 | 31,65 | 28,90 | 17,99 | 15.058 | 13.029 | 434 |
| [750] | FB | 65,00 | 65,51 | 65,00 | 36,93 | 28,11 | 29,02 | 11,50 | 27,60 | (2) | 11,14 | 33,66 | 30,39 | 13,78 | 17.835 | 15.807 | 606 |
| 32" | RB | 70,00 | 70,63 | 70,00 | 36,93 | 28,11 | 29,02 | 11,50 | 27,60 | (2) | 11,14 | 33,66 | 30,39 | 13,78 | 18.078 | 15.807 | 606 |
| [800] | FB | 70,00 | 70,63 | 70,00 | 38,27 | 29,45 | 30,75 | 11,50 | 28,62 | (2) | 11,14 | 35,00 | 31,73 | 17,99 | 19.643 | 17.372 | 611 |
| 34" | RB | 75,98 | 76,61 | 75,98 | 38,27 | 29,45 | 30,75 | 11,50 | 28,62 | (2) | 11,14 | 35,00 | 31,73 | 17,99 | 22.024 | 19.553 | 611 |
| [850] | FB | 75,98 | 76,61 | 75,98 | 40,31 | 30,91 | 32,76 | 11,50 | 30,00 | (2) | 11,14 | 36,26 | 32,99 | 24,02 | 24.471 | 22.000 | 613 |
| 36" | RB | 82,01 | 82,64 | 82,01 | 40,31 | 30,91 | 32,76 | 11,50 | 30,00 | (2) | 11,14 | 36,26 | 32,99 | 24,02 | 26.235 | 23.422 | 613 |
| [900] | FB | 82,01 | 82,64 | 82,01 | 41,65 | 32,24 | 34,49 | 11,50 | 30,00 | (2) | 11,14 | 37,60 | 34,33 | 24,02 | 28.660 | 25.847 | 613 |
| 40" | RB | 92,01 | - | 76,77 | 41,65 | 32,24 | 34,49 | 11,50 | 30,00 | (2) | 11,14 | 37,60 | 34,33 | 24,02 | 30.644 | 27.752 | 613 |
| [1000] | FB | 92,01 | - | 76,77 | 47,24 | 37,20 | 38,50 | 11,50 | 31,22 | (2) | 11,14 | 41,06 | 37,01 | 30,00 | 36.553 | 33.660 | 615 |
| 42" | RB | 93,98 | - | 79,33 | 47,24 | 37,20 | 38,50 | 11,50 | 31,22 | (2) | 11,14 | 41,06 | 37,01 | 30,00 | 39.683 | 36.028 | 615 |
| [1050] | FB | 93,98 | - | 79,33 | 48,43 | 39,37 | 40,24 | 14,02 | 40,47 | (2) | 14,02 | 43,62 | 38,98 | 24,02 | 43.211 | 39.555 | 1.574 |
| 48" | RB | 105,00 | - | 87,40 | 48,43 | 39,37 | 40,24 | 14,02 | 40,47 | (2) | 14,02 | 43,62 | 38,98 | 24,02 | 46.650 | 41.493 | 1.574 |
| [1200] | FB | 105,00 | - | 87,40 | 53,15 | 43,31 | 45,98 | 14,02 | 41,89 | (2) | 14,02 | 49,13 | 44,49 | 30,00 | 56.041 | 50.885 | 1.579 |
| 56" | RB | 105,00 | - | 98,43 | 53,15 | 43,31 | 45,98 | 14,02 | 41,89 | (2) | 14,02 | 49,13 | 44,49 | 30,00 | 57.585 | 49.681 | 1.579 |
| [1400] | FB | 105,00 | - | 98,43 | 57,48 | 50,39 | 53,74 | 17,40 | 46,54 | (2) | 17,72 | 54,33 | 48,43 | 30,00 | 69.203 | 61.299 | 2.571 |
| 60" | RB | 116,14 | - | 103,94 | 57,48 | 50,39 | 53,74 | 17,40 | 46,54 | (2) | 17,72 | 54,33 | 48,43 | 30,00 | 82.365 | 72.197 | 2.571 |
| [1500] | FB | 116,14 | - | 103,94 | 63,78 | 57,09 | 57,52 | 21,14 | 49,57 | (2) | 21,65 | 59,45 | 52,36 | 35,98 | 88.030 | 77.863 | 3.810 |

Standards do not exist for these dimensions - Contact your sales representative.

RB = Reduced Bore
FB = Full Bore

- (1) Lever operated valves
- (2) Gear operated valves
- (3) "L" dimension not shown on sketches is lever length dimension

All measurements and weights are representative of typical model designation; however, actual may vary depending on selection of model, base material, cast or forged design and end connections. Please contact your local sales representative for further clarification.

FCT TRUNNION MOUNTED SPLIT BODY BALL VALVES

MODELS HPA, HRA, DB

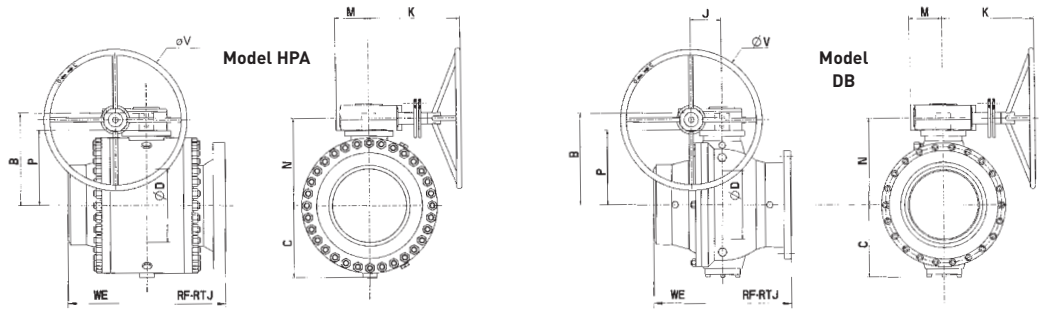

Dimensions ANSI 900 – Full Bore 2" to 60" – Reduced Bore 3" to 60" – Models HPA and DB

| ANSI 900 | Nominal Diameter in. [mm] | RF | RJ | WE | B | C | D | J | K | L(3) | M | N | P | V | Weight (lb) | | |
|----------|------------------------------|--------|--------|--------|-------|-------|-------|-------|-------|-------|-------|-------|-------|-------|-------------|--------|---------------|
| | | | | | | | | | | | | | | | RF-RTJ | WE | Gear operator |
| | | | | | | | | | | | | | | | | | |
| 2" [50] | FB | 14,49 | 14,61 | 14,49 | 4,76 | 3,98 | 2,01 | (1) | (1) | 14,57 | (1) | 6,02 | 3,43 | (1) | 128 | 88 | (1) |
| 3" | RB | 15,00 | 15,12 | 15,00 | 4,76 | 3,98 | 2,01 | (1) | (1) | 14,57 | (1) | 6,02 | 3,43 | (1) | 139 | 90 | (1) |
| [80] | FB | 15,00 | 15,12 | 15,00 | 7,36 | 5,24 | 2,99 | (1) | (1) | 35,43 | (1) | 7,17 | 5,79 | (1) | 203 | 154 | (1) |
| 4" | RB | 17,99 | 18,11 | 17,99 | 7,36 | 5,24 | 2,99 | (1) | (1) | 35,43 | (1) | 7,17 | 5,79 | (1) | 251 | 170 | (1) |
| [100] | FB | 17,99 | 18,11 | 17,99 | 9,72 | 5,91 | 4,02 | 2,05 | 6,85 | (2) | 2,28 | 7,95 | 6,57 | 9,84 | 309 | 227 | 13 |
| 6" | RB | 24,02 | 24,13 | 24,02 | 9,72 | 5,91 | 4,02 | 2,05 | 6,85 | (2) | 2,28 | 7,95 | 6,57 | 9,84 | 463 | 298 | 13 |
| [150] | FB | 24,02 | 24,13 | 24,02 | 10,24 | 8,03 | 5,98 | 3,54 | 12,05 | (2) | 3,90 | 10,35 | 8,39 | 24,02 | 705 | 540 | 42 |
| 8" | RB | 29,02 | 29,13 | 29,02 | 10,24 | 8,03 | 5,98 | 3,54 | 12,05 | (2) | 3,90 | 10,35 | 8,39 | 24,02 | 904 | 624 | 42 |
| [200] | FB | 29,02 | 29,13 | 29,02 | 12,80 | 10,04 | 7,99 | 4,84 | 16,02 | (2) | 4,96 | 12,24 | 10,28 | 30,00 | 1.323 | 1.043 | 75 |
| 10" | RB | 32,99 | 33,11 | 32,99 | 12,80 | 10,04 | 7,99 | 4,84 | 16,02 | (2) | 4,96 | 12,24 | 10,28 | 30,00 | 1.565 | 1.166 | 75 |
| [250] | FB | 32,99 | 33,11 | 32,99 | 15,75 | 12,05 | 10,00 | 2,13 | 19,76 | (2) | 5,67 | 14,49 | 12,36 | 24,02 | 2.006 | 1.607 | 143 |
| 12" | RB | 37,99 | 38,11 | 37,99 | 15,75 | 12,05 | 10,00 | 2,13 | 19,76 | (2) | 5,67 | 14,49 | 12,36 | 24,02 | 2.293 | 1.755 | 143 |
| [300] | FB | 37,99 | 38,11 | 37,99 | 17,91 | 14,21 | 12,01 | 2,13 | 19,76 | (2) | 6,10 | 17,13 | 14,53 | 24,02 | 2.866 | 2.328 | 150 |
| 14" | RB | 40,51 | 40,87 | 40,51 | 17,91 | 14,21 | 12,01 | 2,13 | 19,76 | (2) | 6,10 | 17,13 | 14,53 | 24,02 | 3.064 | 2.429 | 150 |
| [350] | FB | 40,51 | 40,87 | 40,51 | 20,31 | 15,71 | 12,76 | 7,13 | 22,20 | (2) | 7,01 | 18,58 | 16,02 | 17,99 | 3.527 | 2.892 | 258 |
| 16" | RB | 44,49 | 44,88 | 44,49 | 20,31 | 15,71 | 12,76 | 7,13 | 22,20 | (2) | 7,01 | 18,58 | 16,02 | 17,99 | 3.858 | 3.093 | 258 |
| [400] | FB | 44,49 | 44,88 | 44,49 | 22,76 | 16,18 | 14,76 | 11,50 | 28,62 | (2) | 11,14 | 21,54 | 18,27 | 17,99 | 4.982 | 4.217 | 258 |
| 18" | RB | 47,99 | 48,50 | 47,99 | 22,76 | 16,18 | 14,76 | 11,50 | 28,62 | (2) | 11,14 | 21,54 | 18,27 | 17,99 | 5.622 | 4.553 | 258 |
| [450] | FB | 47,99 | 48,50 | 47,99 | 25,04 | 17,72 | 16,73 | 9,33 | 23,07 | (2) | 9,13 | 22,48 | 19,72 | 17,99 | 7.055 | 5.986 | 258 |
| 20" | RB | 52,01 | 52,52 | 52,01 | 25,04 | 17,72 | 16,73 | 9,33 | 23,07 | (2) | 9,13 | 22,48 | 19,72 | 17,99 | 7.760 | 6.433 | 258 |
| [500] | FB | 52,01 | 52,52 | 52,01 | 26,54 | 19,21 | 18,62 | 9,33 | 25,87 | (2) | 9,13 | 23,98 | 21,22 | 30,00 | 8.267 | 6.940 | 419 |
| 22" | RB | 55,98 | 56,50 | 55,98 | 26,54 | 19,21 | 18,62 | 9,33 | 25,87 | (2) | 9,13 | 23,98 | 21,22 | 30,00 | 9.039 | 7.099 | 419 |
| [550] | FB | 55,98 | 56,50 | 55,98 | 31,50 | 22,44 | 20,63 | 9,33 | 26,42 | (2) | 9,13 | 28,46 | 25,20 | 35,98 | 11.574 | 9.634 | 419 |
| 24" | RB | 60,98 | 61,73 | 60,98 | 31,50 | 22,44 | 20,63 | 9,33 | 26,42 | (2) | 9,13 | 28,46 | 25,20 | 35,98 | 12.125 | 9.588 | 419 |
| [600] | FB | 60,98 | 61,73 | 60,98 | 32,64 | 24,13 | 22,52 | 11,50 | 28,62 | (2) | 11,14 | 29,49 | 26,22 | 17,99 | 14.793 | 12.555 | 628 |
| 26" | RB | 63,98 | 64,84 | 63,98 | 32,64 | 24,13 | 22,52 | 11,50 | 28,62 | (2) | 11,14 | 29,49 | 26,22 | 17,99 | 16.314 | 13.702 | 628 |
| [650] | FB | 63,98 | 64,84 | 63,98 | 35,04 | 26,18 | 24,37 | 11,50 | 28,43 | (2) | 11,14 | 31,73 | 28,54 | 17,99 | 17.394 | 14.782 | 628 |
| 28" | RB | 67,99 | 68,86 | 67,99 | 35,04 | 26,18 | 24,37 | 11,50 | 28,43 | (2) | 11,14 | 31,73 | 28,54 | 17,99 | 17.725 | 14.645 | 628 |
| [700] | FB | 67,99 | 68,86 | 67,99 | 37,01 | 28,35 | 26,26 | 11,50 | 29,80 | (2) | 11,14 | 35,04 | 31,69 | 24,02 | 20.723 | 17.644 | 628 |
| 30" | RB | 70,98 | 71,85 | 70,98 | 37,01 | 28,35 | 26,26 | 11,50 | 29,80 | (2) | 11,14 | 35,04 | 31,69 | 24,02 | 21.275 | 17.696 | 628 |
| [750] | FB | 70,98 | 71,85 | 70,98 | 38,98 | 30,71 | 28,11 | 11,50 | 29,80 | (2) | 11,14 | 40,16 | 37,20 | 24,02 | 24.163 | 20.585 | 628 |
| 32" | RB | 75,00 | 75,87 | 75,00 | 38,98 | 30,71 | 28,11 | 11,50 | 29,80 | (2) | 11,14 | 40,16 | 37,20 | 24,02 | 25.221 | 20.913 | 628 |
| [800] | FB | 75,00 | 75,87 | 75,00 | 40,94 | 32,28 | 30,00 | 11,50 | 31,22 | (2) | 11,14 | 40,94 | 37,80 | 30,00 | 29.983 | 25.675 | 628 |
| 34" | RB | 80,00 | 81,10 | 80,00 | 40,94 | 32,28 | 30,00 | 11,50 | 31,22 | (2) | 11,14 | 40,94 | 37,80 | 30,00 | 31.085 | 26.037 | 628 |
| [850] | FB | 80,00 | 81,10 | 80,00 | 42,32 | 33,86 | 31,89 | 14,02 | 40,47 | (2) | 14,02 | 43,70 | 39,17 | 24,02 | 33.797 | 28.748 | 1.574 |
| 36" | RB | 85,91 | 87,13 | 85,91 | 42,32 | 33,86 | 31,89 | 14,02 | 40,47 | (2) | 14,02 | 43,70 | 39,17 | 24,02 | 35.450 | 29.727 | 1.574 |
| [900] | FB | 85,91 | 87,13 | 85,91 | 44,09 | 36,93 | 33,74 | 14,02 | 41,89 | (2) | 14,02 | 44,49 | 40,16 | 30,00 | 39.022 | 33.299 | 1.579 |
| 40" | RB | 94,88 | 95,98 | 94,88 | 44,09 | 36,93 | 33,74 | 14,02 | 41,89 | (2) | 14,02 | 44,49 | 40,16 | 30,00 | 40.345 | 34.136 | 1.579 |
| [1000] | FB | 94,88 | 95,98 | 94,88 | 47,24 | 39,37 | 37,76 | 14,02 | 43,35 | (2) | 14,02 | 45,67 | 41,34 | 35,98 | 48.502 | 42.293 | 1.605 |
| 42" | RB | 99,02 | 100,00 | 99,02 | 47,24 | 39,37 | 37,76 | 14,02 | 43,35 | (2) | 14,02 | 45,67 | 41,34 | 35,98 | 50.927 | 44.033 | 1.605 |
| [1050] | FB | 99,02 | 100,00 | 99,02 | 52,17 | 42,52 | 39,49 | 14,02 | 41,89 | (2) | 14,02 | 47,24 | 42,91 | 30,00 | 57.320 | 50.426 | 1.579 |
| 48" | RB | 103,15 | 112,20 | 94,49 | 52,17 | 42,52 | 39,49 | 14,02 | 41,89 | (2) | 14,02 | 47,24 | 42,91 | 30,00 | 65.499 | 55.475 | 1.579 |
| [1200] | FB | 103,15 | 112,20 | 94,49 | 56,10 | 47,24 | 45,47 | 14,02 | 42,95 | (2) | 14,02 | 52,36 | 48,03 | 35,98 | 72.312 | 62.287 | 1.605 |
| 56" | RB | 111,02 | - | 98,43 | 56,10 | 47,24 | 45,47 | 14,02 | 42,95 | (2) | 14,02 | 52,36 | 48,03 | 35,98 | 79.587 | 66.028 | 1.605 |
| [1400] | FB | 111,02 | - | 98,43 | 60,63 | 53,54 | 52,64 | 25,71 | 51,65 | (2) | 26,38 | 60,83 | 52,36 | 30,00 | 92.087 | 78.529 | 5.106 |
| 60" | RB | 115,35 | - | 102,36 | 60,63 | 53,54 | 52,64 | 25,71 | 51,65 | (2) | 26,38 | 60,83 | 52,36 | 30,00 | 111.929 | 92.307 | 5.106 |
| [1500] | FB | 115,35 | - | 102,36 | 69,88 | 63,98 | 56,61 | 25,71 | 52,72 | (2) | 26,38 | 64,57 | 56,10 | 35,98 | 116.580 | 96.959 | 5.132 |

Standards do not exist for these dimensions - Contact your sales representative.

RB = Reduced Bore
FB = Full Bore

- (1) Lever operated valves
- (2) Gear operated valves
- (3) "L" dimension not shown on sketches is lever length dimension

All measurements and weights are representative of typical model designation; however, actual may vary depending on selection of model, base material, cast or forged design and end connections. Please contact your local sales representative for further clarification.

FCT TRUNNION MOUNTED SPLIT BODY BALL VALVES

MODELS HPA, HRA, DB

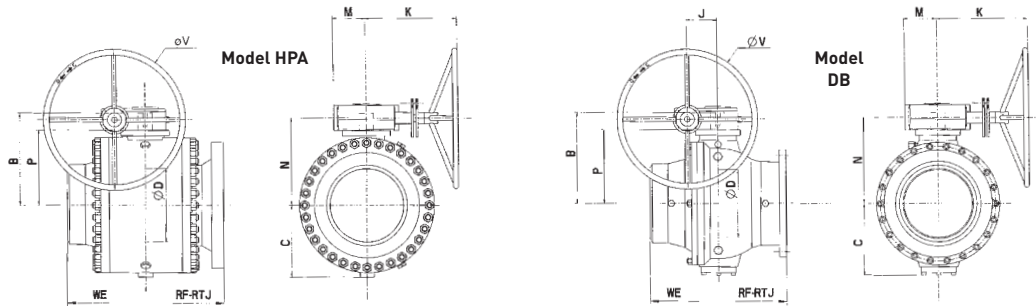

Dimensions ANSI 1500 – Full Bore 2" to 60" – Reduced Bore 3" to 60" – Models HPA and DB

| Nominal Diameter | in. [mm] | RF | RJ | WE | B | C | D | J | K | L(3) | M | N | P | V | Weight lb. | | | |
|------------------|----------|----|--------|--------|--------|-------|-------|-------|-------|-------|-------|-------|-------|-------|------------|--------|---------------|-------|
| | | | | | | | | | | | | | | | RF-RTJ | WE | Gear operator | |
| 2" | [50] | FB | 14,49 | 14,61 | 14,49 | 6,06 | 3,74 | 2,01 | (1) | (1) | 19,69 | (1) | 6,50 | 4,72 | (1) | 128 | 88 | (1) |
| 3" | | RB | 18,50 | 18,62 | 18,50 | 6,06 | 3,74 | 2,01 | (1) | (1) | 19,69 | (1) | 6,50 | 4,72 | (1) | 172 | 97 | (1) |
| [80] | | FB | 18,50 | 18,62 | 18,50 | 7,36 | 5,00 | 2,99 | 2,05 | 6,85 | (2) | 2,28 | 7,17 | 5,79 | 9,84 | 243 | 168 | 13 |
| 4" | | RB | 21,50 | 21,61 | 21,50 | 7,36 | 5,00 | 2,99 | 2,05 | 6,85 | (2) | 2,28 | 7,17 | 5,79 | 9,84 | 298 | 185 | 13 |
| [100] | | FB | 21,50 | 21,61 | 21,50 | 8,54 | 6,22 | 4,02 | 2,64 | 8,98 | (2) | 2,95 | 8,23 | 6,57 | 13,78 | 419 | 306 | 24 |
| 6" | | RB | 27,76 | 27,99 | 27,76 | 8,54 | 6,22 | 4,02 | 2,64 | 8,98 | (2) | 2,95 | 8,23 | 6,57 | 13,78 | 639 | 379 | 24 |
| [150] | | FB | 27,76 | 27,99 | 27,76 | 11,18 | 8,74 | 5,75 | 4,84 | 14,61 | (2) | 4,96 | 11,30 | 9,33 | 24,02 | 1.102 | 842 | 71 |
| 8" | | RB | 32,76 | 33,11 | 32,76 | 11,18 | 8,74 | 5,75 | 4,84 | 14,61 | (2) | 4,96 | 11,30 | 9,33 | 24,02 | 1.367 | 939 | 71 |
| [200] | | FB | 32,76 | 33,11 | 32,76 | 13,54 | 9,72 | 7,64 | 6,06 | 17,01 | (2) | 6,22 | 13,07 | 11,10 | 30,00 | 1.786 | 1.358 | 134 |
| 10" | | RB | 39,02 | 39,37 | 39,02 | 13,54 | 9,72 | 7,64 | 6,06 | 17,01 | (2) | 6,22 | 13,07 | 11,10 | 30,00 | 2.271 | 1.532 | 134 |
| [250] | | FB | 39,02 | 39,37 | 39,02 | 17,80 | 12,32 | 9,49 | 2,13 | 21,18 | (2) | 6,10 | 16,77 | 14,17 | 30,00 | 3.086 | 2.348 | 148 |
| 12" | | RB | 44,49 | 45,12 | 44,49 | 17,80 | 12,32 | 9,49 | 2,13 | 21,18 | (2) | 6,10 | 16,77 | 14,17 | 30,00 | 3.704 | 2.617 | 148 |
| [300] | | FB | 44,49 | 45,12 | 44,49 | 20,16 | 13,90 | 11,38 | 3,82 | 22,44 | (2) | 7,01 | 18,43 | 15,87 | 30,00 | 4.740 | 3.653 | 265 |
| 14" | | RB | 49,49 | 50,24 | 49,49 | 20,16 | 13,90 | 11,38 | 3,82 | 22,44 | (2) | 7,01 | 18,43 | 15,87 | 30,00 | 5.401 | 3.946 | 265 |
| [350] | | FB | 49,49 | 50,24 | 49,49 | 22,09 | 14,96 | 12,52 | 9,33 | 24,45 | (2) | 9,13 | 19,53 | 16,77 | 24,02 | 6.878 | 5.423 | 265 |
| 16" | | RB | 54,49 | 55,39 | 54,49 | 22,09 | 14,96 | 12,52 | 9,33 | 24,45 | (2) | 9,13 | 19,53 | 16,77 | 24,02 | 8.113 | 6.210 | 401 |
| [400] | | FB | 54,49 | 55,39 | 54,49 | 23,66 | 16,54 | 14,25 | 9,33 | 25,87 | (2) | 9,13 | 21,10 | 18,35 | 30,00 | 9.833 | 7.930 | 408 |
| 18" | | RB | 60,51 | 61,38 | 60,51 | 23,66 | 16,54 | 14,25 | 9,33 | 25,87 | (2) | 9,13 | 21,10 | 18,35 | 30,00 | 10.626 | 7.930 | 408 |
| [450] | | FB | 60,51 | 61,38 | 60,51 | 30,16 | 22,05 | 14,61 | 11,50 | 27,60 | (2) | 11,14 | 27,09 | 23,82 | 13,78 | 12.897 | 10.201 | 408 |
| 20" | | RB | 65,51 | 66,38 | 65,51 | 30,16 | 22,05 | 14,61 | 11,50 | 27,60 | (2) | 11,14 | 27,09 | 23,82 | 13,78 | 14.639 | 11.283 | 408 |
| [500] | | FB | 65,51 | 66,38 | 65,51 | 31,69 | 23,58 | 16,38 | 11,50 | 28,62 | (2) | 11,14 | 28,62 | 25,35 | 17,99 | 17.196 | 13.841 | 611 |
| 22" | | RB | 70,91 | 72,01 | 70,91 | 31,69 | 23,58 | 16,38 | 11,50 | 28,62 | (2) | 11,14 | 28,62 | 25,35 | 17,99 | 18.409 | 14.220 | 611 |
| [550] | | FB | 70,91 | 72,01 | 70,91 | 33,07 | 25,98 | 17,99 | 11,50 | 29,80 | (2) | 11,14 | 30,04 | 26,77 | 24,02 | 21.076 | 16.887 | 611 |
| 24" | | RB | 76,50 | 77,64 | 76,50 | 33,07 | 25,98 | 17,99 | 11,50 | 29,80 | (2) | 11,14 | 30,04 | 26,77 | 24,02 | 24.471 | 19.055 | 611 |
| [600] | | FB | 76,50 | 77,64 | 76,50 | 33,90 | 26,57 | 19,61 | 11,50 | 30,00 | (2) | 11,14 | 31,61 | 28,35 | 24,02 | 26.632 | 21.215 | 611 |
| 26" | | RB | 80,63 | 81,77 | 80,63 | 33,90 | 26,57 | 19,61 | 11,50 | 30,00 | (2) | 11,14 | 31,61 | 28,35 | 24,02 | 28.881 | 22.774 | 611 |
| [650] | | FB | 80,63 | 81,77 | 80,63 | 36,61 | 29,92 | 21,26 | 11,50 | 31,22 | (2) | 11,14 | 33,58 | 30,31 | 30,00 | 30.644 | 24.537 | 615 |
| 28" | | RB | 84,57 | 85,67 | 84,57 | 36,61 | 29,92 | 21,26 | 11,50 | 31,22 | (2) | 11,14 | 33,58 | 30,31 | 30,00 | 31.526 | 22.972 | 615 |
| [700] | | FB | 84,57 | 85,67 | 84,57 | 38,58 | 33,39 | 22,99 | 14,02 | 40,47 | (2) | 14,02 | 36,93 | 32,28 | 24,02 | 34.392 | 25.838 | 1.574 |
| 30" | | RB | 88,62 | 89,80 | 88,62 | 38,58 | 33,39 | 22,99 | 14,02 | 40,47 | (2) | 14,02 | 36,93 | 32,28 | 24,02 | 37.919 | 27.161 | 1.574 |
| [750] | | FB | 88,62 | 89,80 | 88,62 | 46,85 | 36,81 | 24,61 | 14,02 | 41,89 | (2) | 14,02 | 42,13 | 37,40 | 30,00 | 41.337 | 30.578 | 1.579 |
| 32" | | RB | 92,36 | 93,70 | 92,36 | 46,85 | 36,81 | 24,61 | 14,02 | 41,89 | (2) | 14,02 | 42,13 | 37,40 | 30,00 | 51.037 | 38.393 | 1.579 |
| [800] | | FB | 92,36 | 93,70 | 92,36 | 53,03 | 39,37 | 26,38 | 14,02 | 43,35 | (2) | 14,02 | 47,24 | 42,60 | 35,98 | 55.116 | 42.472 | 1.605 |
| 34" | | RB | 96,46 | 96,61 | 96,46 | 53,03 | 39,37 | 26,38 | 14,02 | 43,35 | (2) | 14,02 | 47,24 | 42,60 | 35,98 | 59.216 | 44.555 | 1.605 |
| [850] | | FB | 96,46 | 96,61 | 96,46 | 59,06 | 41,93 | 28,35 | 14,02 | 41,89 | (2) | 14,02 | 51,57 | 46,85 | 30,00 | 67.682 | 53.021 | 1.579 |
| 36" | | RB | 100,63 | 101,97 | 100,63 | 59,06 | 41,93 | 28,35 | 14,02 | 41,89 | (2) | 14,02 | 51,57 | 46,85 | 30,00 | 71.121 | 53.815 | 1.579 |
| [900] | | FB | 100,63 | 101,97 | 100,63 | 66,14 | 44,88 | 30,00 | 14,02 | 42,95 | (2) | 14,02 | 56,69 | 51,97 | 35,98 | 82.894 | 65.587 | 1.605 |
| 40" | | RB | - | - | - | - | - | - | - | - | - | - | - | - | - | - | - | - |
| [1000] | | FB | - | - | - | - | - | - | - | - | - | - | - | - | - | - | - | - |
| 42" | | RB | - | - | - | - | - | - | - | - | - | - | - | - | - | - | - | - |
| [1050] | | FB | - | - | - | - | - | - | - | - | - | - | - | - | - | - | - | - |

Standards do not exist for these dimensions - Contact your sales representative.

RB = Reduced Bore
FB = Full Bore

- (1) Lever operated valves
- (2) Gear operated valves
- (3) "L" dimension not shown on sketches is lever length dimension

All measurements and weights are representative of typical model designation; however, actual may vary depending on selection of model, base material, cast or forged design and end connections. Please contact your local sales representative for further clarification.

FCT TRUNNION MOUNTED SPLIT BODY BALL VALVES

MODELS HPA, HRA, DB

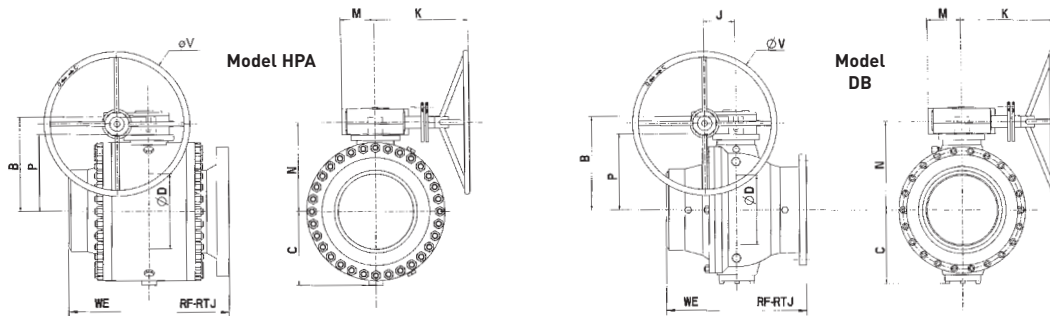

Dimensions ANSI 2500 – Full Bore 2" to 30" – Reduced Bore 3" to 30" – Models HPA and DB

| Nominal Diameter in. [mm] | | RF | RJ | WE | B | C | D | J | K | L(3) | M | N | P | V | Weight (lb) | | |
|------------------------------|----|-------|-------|-------|-------|-------|-------|-------|-------|-------|-------|-------|-------|-------|-------------|-------|---------------|
| | | | | | | | | | | | | | | | RF-RTJ | WE | Gear operator |
| 2" [50] | FB | 17,76 | 17,87 | 17,76 | 6,85 | 4,72 | 1,73 | (1) | (1) | 35,43 | (1) | 7,01 | 5,63 | (1) | 50 | 37 | (1) |
| 3" | RB | 22,76 | 22,99 | 22,76 | 6,85 | 4,72 | 1,73 | (1) | (1) | 35,43 | (1) | 7,24 | 5,63 | (1) | 70 | 41 | (1) |
| [80] | FB | 22,76 | 22,99 | 22,76 | 8,82 | 5,87 | 2,52 | 2,64 | 10,00 | (2) | 2,95 | 8,11 | 6,46 | 17,99 | 100 | 70 | 5 |
| 4" | RB | 26,50 | 26,89 | 26,50 | 8,82 | 5,87 | 2,52 | 2,64 | 10,00 | (2) | 2,95 | 8,11 | 6,46 | 17,99 | 118 | 73 | 5 |
| [100] | FB | 26,50 | 26,89 | 26,50 | 10,55 | 7,09 | 3,50 | 3,54 | 12,05 | (2) | 3,90 | 10,16 | 8,19 | 24,02 | 168 | 123 | 9 |
| 6" | RB | 35,98 | 36,50 | 35,98 | 10,55 | 7,09 | 3,50 | 3,54 | 12,05 | (2) | 3,90 | 10,16 | 8,19 | 24,02 | 261 | 145 | 9 |
| [150] | FB | 35,98 | 36,50 | 35,98 | 14,61 | 10,83 | 5,24 | 6,06 | 17,01 | (2) | 6,22 | 13,43 | 11,46 | 30,00 | 431 | 315 | 30 |
| 8" | RB | 40,24 | 40,87 | 40,24 | 14,61 | 10,83 | 5,24 | 6,06 | 17,01 | (2) | 6,22 | 13,43 | 11,46 | 30,00 | 508 | 339 | 30 |
| [200] | FB | 40,24 | 40,87 | 40,24 | 17,56 | 13,19 | 7,13 | 2,13 | 21,18 | (2) | 6,10 | 16,54 | 13,94 | 30,00 | 689 | 521 | 30 |
| 10" | RB | 50,00 | 50,87 | 50,00 | 17,56 | 13,19 | 7,13 | 2,13 | 21,18 | (2) | 6,10 | 16,54 | 13,94 | 30,00 | 903 | 581 | 30 |
| [250] | FB | 50,00 | 50,87 | 50,00 | 22,44 | 17,01 | 8,86 | 9,33 | 23,07 | (2) | 9,13 | 21,26 | 18,50 | 17,99 | 1.315 | 993 | 83 |
| 12" | RB | 55,98 | 56,89 | 55,98 | 22,44 | 17,01 | 8,86 | 9,33 | 23,07 | (2) | 9,13 | 21,26 | 18,50 | 17,99 | 1.520 | 1.062 | 83 |
| [300] | FB | 55,98 | 56,89 | 55,98 | 27,48 | 20,67 | 10,51 | 9,33 | 24,45 | (2) | 9,13 | 25,12 | 22,36 | 24,02 | 2.114 | 1.656 | 83 |
| 14" | RB | 60,63 | 61,77 | 60,63 | 27,48 | 20,67 | 10,51 | 9,33 | 24,45 | (2) | 9,13 | 25,12 | 22,36 | 24,02 | 2.141 | 1.542 | 83 |
| [350] | FB | 60,63 | 61,77 | 60,63 | 29,25 | 21,65 | 9,49 | 9,33 | 25,87 | (2) | 9,13 | 26,10 | 23,35 | 30,00 | 2.200 | 1.601 | 83 |
| 16" | RB | 61,69 | 62,83 | 61,69 | 29,25 | 21,65 | 9,49 | 9,33 | 25,87 | (2) | 9,13 | 26,10 | 23,35 | 30,00 | 2.313 | 1.374 | 83 |
| [400] | FB | 61,69 | 62,83 | 61,69 | 33,50 | 25,43 | 10,87 | 11,50 | 28,62 | (2) | 11,14 | 30,08 | 26,81 | 17,99 | 3.529 | 2.590 | 126 |
| 18" | RB | 71,85 | 72,99 | 71,85 | 33,50 | 25,43 | 10,87 | 11,50 | 28,62 | (2) | 11,14 | 30,08 | 26,81 | 17,99 | 4.037 | 2.799 | 126 |
| [450] | FB | 71,85 | 72,99 | 71,85 | 36,38 | 28,70 | 12,24 | 11,50 | 30,00 | (2) | 11,14 | 33,35 | 30,08 | 24,02 | 4.563 | 3.325 | 324 |
| 20" | RB | 73,82 | 74,96 | 73,82 | 36,38 | 28,70 | 12,24 | 11,50 | 30,00 | (2) | 11,14 | 33,35 | 30,08 | 24,02 | 5.216 | 3.606 | 324 |
| [500] | FB | 73,82 | 74,96 | 73,82 | 40,28 | 30,12 | 13,50 | 11,50 | 31,42 | (2) | 11,14 | 34,13 | 30,87 | 30,00 | 6.151 | 4.540 | 325 |
| 22" | RB | 80,91 | 82,13 | 80,91 | 40,28 | 30,12 | 13,50 | 11,50 | 31,42 | (2) | 11,14 | 34,13 | 30,87 | 30,00 | 6.713 | 4.595 | 325 |
| [550] | FB | 80,91 | 82,13 | 80,91 | 44,49 | 33,07 | 14,88 | 14,02 | 40,47 | (2) | 14,02 | 38,58 | 33,86 | 24,02 | 7.648 | 5.529 | 324 |
| 24" | RB | 88,86 | 90,00 | 88,86 | 44,49 | 33,07 | 14,88 | 14,02 | 40,47 | (2) | 14,02 | 38,58 | 33,86 | 24,02 | 8.187 | 5.443 | 324 |
| [600] | FB | 88,86 | 90,00 | 88,86 | 49,21 | 36,22 | 16,26 | 14,02 | 42,09 | (2) | 14,02 | 41,73 | 37,01 | 30,00 | 9.435 | 6.690 | 325 |
| 26" | RB | - | - | - | - | - | - | - | - | - | - | - | - | - | - | - | - |
| [650] | RB | - | - | - | - | - | - | - | - | - | - | - | - | - | - | - | - |
| 28" | FB | - | - | - | - | - | - | - | - | - | - | - | - | - | - | - | - |
| [700] | RB | - | - | - | - | - | - | - | - | - | - | - | - | - | - | - | - |
| 30" | RB | - | - | - | - | - | - | - | - | - | - | - | - | - | - | - | - |
| [750] | FB | - | - | - | - | - | - | - | - | - | - | - | - | - | - | - | - |

Standards do not exist for these dimensions - Contact your sales representative.

- (1) Lever operated valves
- (2) Gear operated valves
- (3) "L" dimension not shown on sketches is lever length dimension

RB = Reduced Bore
FB = Full Bore

All measurements and weights are representative of typical model designation; however, actual may vary depending on selection of model, base material, cast or forged design and end connections. Please contact your local sales representative for further clarification.

FCT TRUNNION MOUNTED SPLIT BODY BALL VALVES

MODELS HPA, HRA, DB

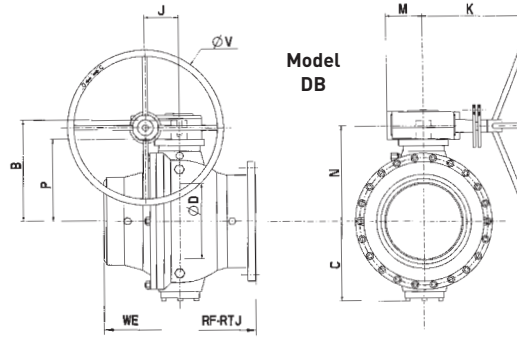

Dimensions API 10,000 – Full Bore 1³/₁₆" to 2¹/₄" – Reduced Bore 2¹/₁₆" to 2¹/₄" – Model DB

| Nominal Diameter | in. [mm] | RF | RJ | WE | B | C | D | J | K | L(3) | M | N | P | V | Weight (lb) | | | | |
|------------------|--|----|----|-------|-------|-------|-------|-------|-------|-------|-------|-------|-------|-------|-------------|--------|---------------|-------|---|
| | | | | | | | | | | | | | | | RF-RTJ | WE | Gear operator | | |
| API 10,000 | 1 ³ / ₁₆ " [46] | FB | - | 18,23 | 18,23 | 7,09 | 5,71 | 1,81 | (1) | (1) | 35,43 | (1) | 6,89 | 5,71 | (1) | 154 | 121 | (1) | |
| | 2 ¹ / ₁₆ " [52] | FB | - | 20,51 | 20,51 | 7,09 | 5,71 | 1,81 | (1) | (1) | 35,43 | (1) | 6,89 | 5,71 | (1) | 176 | 137 | (1) | |
| | 2 ⁹ / ₁₆ " [65] | FB | - | 22,24 | 22,24 | 9,65 | 6,97 | 2,56 | 3,54 | 10,98 | (2) | 3,90 | 8,94 | 6,97 | 17,99 | 397 | 335 | 71 | |
| | 3 ¹ / ₁₆ " [78] | FB | - | 24,37 | 24,37 | 9,65 | 6,97 | 2,56 | 3,54 | 10,98 | (2) | 3,90 | 8,94 | 6,97 | 21,54 | 507 | 412 | 71 | |
| | 4 ¹ / ₁₆ " [103] | FB | - | 26,38 | 26,38 | 11,18 | 7,95 | 3,07 | 3,54 | 12,36 | (2) | 3,90 | 10,67 | 8,70 | 24,02 | 661 | 567 | 71 | |
| | 5 ¹ / ₈ " [130] | FB | - | 29,02 | 29,02 | 14,84 | 11,22 | 5,12 | 2,36 | 20,98 | (2) | 6,10 | 15,35 | 11,42 | 30,00 | 2,315 | 2,099 | 152 | |
| | 7 ¹ / ₁₆ " [179] | FB | - | 40,94 | 40,94 | 20,28 | 16,50 | 7,05 | 9,33 | 24,29 | (2) | 9,13 | 19,17 | 16,42 | 24,02 | 4,740 | 4,242 | 401 | |
| | 9" [228] | FB | - | 47,24 | 47,24 | 26,38 | 20,87 | 8,98 | 11,50 | 28,43 | (2) | 11,14 | 24,45 | 21,18 | 17,99 | 9,811 | 9,043 | 611 | |
| | 11" [279] | FB | - | 55,98 | 55,98 | 32,28 | 25,59 | 10,98 | 11,50 | 31,22 | (2) | 11,14 | 29,53 | 25,98 | 30,00 | 17,946 | 16,737 | 615 | |
| | 13 ⁵ / ₈ " [346] | FB | - | 62,83 | 62,83 | 40,16 | 31,89 | 13,62 | 14,57 | 38,78 | (2) | 14,17 | 37,01 | 32,28 | 30,00 | 34,238 | 32,311 | 1,587 | |
| | 16 ³ / ₄ " [425] | FB | - | 70,00 | 70,00 | 40,16 | 31,89 | 13,62 | 14,57 | 38,78 | (2) | 14,17 | 37,01 | 32,28 | 30,00 | 35,715 | 32,538 | 1,587 | |
| | 18 ³ / ₄ " [476] | FB | - | - | - | - | - | - | - | - | - | - | - | - | - | - | - | - | - |
| | 21 ¹ / ₄ " [540] | FB | - | - | - | - | - | - | - | - | - | - | - | - | - | - | - | - | - |

Standards do not exist for these dimensions - Contact your sales representative.

RB = Reduced Bore
FB = Full Bore

- (1) Lever operated valves
- (2) Gear operated valves
- (3) "L" dimension not shown on sketches is lever length dimension

All measurements and weights are representative of typical model designation; however, actual may vary depending on selection of model, base material, cast or forged design and end connections. Please contact your local sales representative for further clarification.

Reduced bore dimensions conform to API 6D Section 6.2.2

Valves DN 300 (NPS 12) and below: one size below nominal size of valve

Valves DN 350 (NPS 14) to DN 600 (NPS 24): two sizes below nominal size of valve

Valves above DN 600 (NPS 24): by agreement

Note:

The "reduced bore dimensions" table specifies the corresponding bore sizes within the dimensional tables. More important bore reductions are supplied as standard or special designs.