

Pipeline Ancillaries

Sight Glasses / Flow Indicators DA 4.11



Flow Indicator with Calibrated Scale

Technical Data

Connection DN	15 - 150
Nominal Pressure PN	DN 15 - 50: PN 16 DN 65 - 150: PN 10
Operating Pressure	DN 15 - 50: max. 16 bar DN 65 - 150: max. 8 bar
Accuracy	± 5% of the end scale value
Temperature	150 °C
Medium	liquids

Description

The DA 4.11 flow meter with vane and calibrated scale is used for metering the flow of low-viscosity transparent liquids and for visually checking the fluid through the sightglasses.

The internal weight-loaded indicating vane indicates the flow volume on a calibrated scale in m³/h water at 20 °C. From size DN 65 up two different measuring ranges are available. The indication is only local, i.e. readings cannot be taken remotely.

The indication is only local, i.e. readings cannot be taken remotely.

Installation: horizontal, with vane pointing downward
Flow direction: from left to right

Standard

- » 2 soda lime glasses, 1 glass with calibrated scale

Options

- » various seal materials suitable for your medium
- » rubber or plastic coating for corrosive media
- » special versions on request

Operating instructions, know how and safety instructions must be observed. All the pressure has always been indicated as overpressure. We reserve the right to alter technical specifications without notice.



Measuring Ranges [m³/h] for water 20 °C

nominal diameter DN	15	25	40	50
measuring range m ³ /h	0.15-1.2	0.3-3	0.7-7	1.2-12

Measuring Ranges [m³/h] for water 20 °C

nominal diameter DN	65	80	100	125	150
measuring range m ³ /h	2.5-25	5-50	5-50	5-50	5-60
	5-50	7-70	10-120	10-140	10-160

Pipeline Ancillaries

Sight Glasses / Flow Indicators DA 4.11

Flow Indicator with Calibrated Scale



Materials

Nominal Diameter	DN 15 - 40	DN 50	DN 65 - 150
Body	up to DN 25 grey cast iron from DN 40 spheroidal cast iron		grey cast iron
Seal	Nova Universal	Nova Universal	NBR
Glasses	soda lime glass, 1 glass with calibrated scale		
Internals	CrNiMo-steel	CrNiMo-St / Ms	CrNiMo-steel

Dimensions [mm]

size	nominal diameter DN								
	15	25	40	50	65	80	100	125	150
A	140	160	200	230	290	310	350	400	400
B	140	140	140	180	200	240	280	295	325
D	85	85	85	110	210	235	280	300	300
øE	50	50	50	66	145	170	210	220	220

Weights [kg]

nominal diameter DN									
15	25	40	50	65	80	100	125	150	
3.5	5	7	10	20	27	48	64	71	

Dimensional Drawing

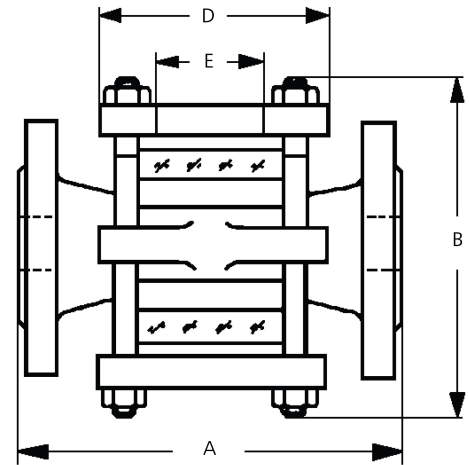

Special designs on request.

The pressure has always been indicated as overpressure.

Mankenberg reserves the right to alter or improve the designs or specifications of the products described herein without notice.